

Model. CR2T

Oil Filled Radiator 2000W with Timer & Thermostat



Features & Benefits

- 9 fins - 15cm with 5 oil channels per fin 3 heat settings 500W / 1000W / 2000W
- Complete with a 24hrs timer with 15 mins segments
- Adjustable room thermostat with easy to set on/off function
- Wheels for easy movement, convenient cord storage, and carrying handle
- Off white body colour with dark grey control panel delivered in full colour packaging boxes

Safety Information

IMPORTANT - Before undertaking any work on or maintenance of fitting:-

- Switch off power supply and allow sufficient time to cool before handling
- Do not dispose of decommissioned fitting in household waste
- Dispose of fitting in the appropriate section of your local civic amenity site or recycling centre only

Technical Specifications

General Information	
Product Colour/Finish	White
Dimensions (mm)	540 x 660 x 165mm
Ingress Protection (IP)	IP20
Electrical	
Input Voltage (V)	220-240V
Output Rating (W)	2000W
Frequency (Hz)	50Hz
Working temperature (°C)	n/a
Mounting Position	Floor
Mounting Bracket (Y/N)	N (Fitted with wheels)
Cable	1.7Mtr 3 core cable fitted with BS1362 approved plug
Class	I
Approvals	BSEN 60335-1:2012 EN50366; 2003+A1, CE, GS, RoHS
Energy Rating (ErP)	n/a
Performance Data	
Air Volume/Velocity (cbm)	n/a
Noise level (dB)	No Noise
Tip-Over Sensor (Y/N)	Y
Over-Heat protection (Y/N)	Y
Construction	
Body	Cold rolled steel plates
Grill	No grill
Motor	No motor
Nett Weight	9.5Kg
Gross Weight	10.3Kg
Warranty Period (Years)	1Yr
Other	
Applications	Domestic, commercial applications

AIRMASTER
HEATING & VENTILATION

OIL FILLED RADIATOR
220 - 240V ~ 50Hz, 1500W - 2500W

TIMER 24 HOURS | THERMAL PROTECTION | IP20 INGRESS PROTECTION | Class I | INTERIOR USE ONLY | CE

INSTRUCTION/OPERATION MANUAL
Product Codes: CR25, CR2T, CR2, CR15T, CR15



Please read these instructions carefully before using your new heater

THIS PRODUCT IS ONLY SUITABLE FOR WELL INSULATED SPACE AND OCCASIONAL USE

Thank you for choosing our Oil Filled Radiator Heater. This owner's manual will provide you with valuable information necessary for the proper care and maintenance of your new product. Please take a few moments to thoroughly read the instructions and familiarize yourself with all the operational aspects of your new heater before use and keep this instruction manual for future reference

44 - 48 FRESHWATER ROAD, DAGENHAM, ESSEX, RM8 1RX (UK)
E: info@cedelectrical.co.uk | W: www.cedelectrical.co.uk
T: 020 8503 8500 | F: 020 8503 8900

- When using an electrical appliance, basic safety precautions should always be observed, including the following:
WARNING: To reduce the risk of fire, electrical shock, or injury to person:
1. This appliance is not intended for use by persons (including children) with reduced physical, sensory or mental capabilities, or lack of experience and knowledge, unless they have been given supervision or instruction concerning use of the appliance by a person responsible for their safety.
 2. Children should be supervised to ensure that they do not play with the appliance.
 3. The product is for household use only.
 4. Connect the appliance to single phase AC supply of the voltage specified on the rating plate.
 5. In order to avoid overheating, do not cover the heater.
 6. Never leave the heater unattended while it is in use. Always turn the product to the OFF position and unplug it from the electrical outlet when not in use.
 7. Extreme caution is necessary when any heater is used by or near children, reduced physical, sensory or mental capabilities or elderly person and whenever the heater is left operating and unattended.
 8. The heater must not be located immediately below an

- electrical socket-outlet.
9. Do not run cord under carpeting and do not cover cord with throw rugs, runners or the like. Arrange cord away from traffic area and where it will not be tripped over.
 10. Do not operate the heater with a damaged cord or plug, or after the heater malfunctions, has been dropped, or damaged in any manner.
 11. If the supply cord is damaged, it must be replaced by the manufacturer or its service agent or a similarly qualified person to avoid a hazard.
 12. Avoid the use of an extension cord as this may overheat and cause a risk of fire.
 13. Use the heater in a well-ventilated area. Do not insert or allow objects to enter any ventilation or exhaust opening. To prevent a possible fire, do not block air intakes or exhaust openings in any manner. Do not use on soft surfaces, like a bed, where openings may become blocked. Use the heater on flat, dry surfaces only.
 14. Do not place this heater near flammable materials, surfaces or substances, as there may be a risk of fire. Keep the above flammable materials, surfaces or substances at least 1m from the front of the product and keep them away from the sides and rear.

15. Do not use the heater in any areas where petrol, paint or other flammable liquids are stored e.g. Garages or workshops as a hot, arcing or sparking parts inside the heater.
16. Don't use this heater in the immediate surroundings of a bath, a shower or a swimming pool. Never locate the heater where it may fall into bathtub or other water container.
17. This heater is hot when in use. To avoid burns and personal injury, do not let bare skin touch hot surfaces. If provided, use handles when moving the product.
18. Be sure that no other appliances are in use on the same electrical circuit as your product as an overload can occur.
19. This heater is filled with a precise quantity of special oil.
20. Repair requiring opening of the oil container are only to be made by the manufacturer or its service agent who should be contacted if there is an oil leakage.
21. Regulations concerning the disposal of oil when scrapping the appliance have to be followed.
22. The heater should not be used in a room, of which the floor area is less than 5 M².
23. The cord shouldn't be placed nearby the hot surface of the appliance.

22. The heater should not be used in a room, of which the floor area is less than 5 M².
23. The cord shouldn't be placed nearby the hot surface of the appliance.

YL-A06FT SPECIFICATIONS



1. Thermostat knob	4. Cord storage
2. Power switch	5. Radiant fins
3. Timer	6. Castor

ASSEMBLY INSTRUCTIONS

The heater is packaged with the feet unattached. You must attach them before operating the heater.
WARNING: Do not operate without feet attached. Do operate the heater only in upright position (feet on the bottom, controls on the top), any other position could create a hazardous situation.

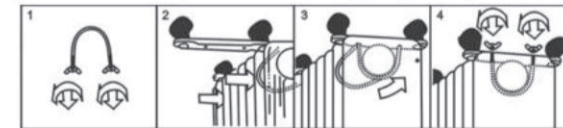

1. Place the radiator body upside-down on a scratch-free location, make sure it is stable and will not fall.
2. Screw off the wing nuts from the U-shaped bolt provided, attach the U-shaped bolt to the U-facing flange between first and second fins (near the front cover).
3. To attach the castor mounting plate to the radiator body, you should insert the threaded ends of the U bolt in the holes on the castor mounting plate.
4. Screw the wing nuts back to the U bolt and fasten the wing nut properly.
Note: do not over tighten, which may cause the damage of radiator flange.
5. Screw off spherical nut from the castor, align the shaft to the hole of the castor mounting plate, insert in, and screw on the spherical nut.
6. Repeat 2, 3, 4 and 5 on the rear of radiator for mounting of the rear castors.
Note: the rear castors must be mounted between the end two fins.

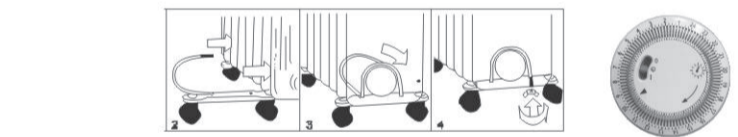

TIMER MANUAL

1. Regulate the time of timer according to the clock by turn it clockwise (DO NOT TURN IT COUNTER CLOCKWISE)
2. The timer has a small switch, the function is as follow: I=Unit is always On; II=Timer function is ON
3. Set the timer to II position. There are 96 small plastic pins on the timer, each correspond to 15 minutes interval. Push outward the pins corresponding to the time you want the heater to turn ON and push inward the pins corresponding to the timer you want the heater to turn OFF

CAUTION:

1. Do not use the timer function unattended.
2. The heater will not operate if timer is set to the II position and the pins are not activated according to the times required.
3. If the heater loses its electricity supply, e.g. Switch off at the mains socket or in the even of a power failure, the time should be reset after the power on again.
4. The pilot light will be on when the timer is set to ON position or the timing function is activated.

INSTRUCTIONS FOR USE

1. Before using the heater, make sure that it is on a flat and stable surface. Damage may occur if it is placed on an incline or decline.
2. Set all the controls to OFF position and insert the plug into a socket-outlet which is well grounded. Be sure that plug fits firmly.
3. Rotate the thermostat knob clockwise to MAX position and switch the heater on as follow: the switch I for low heat, the switch II for medium heat and both switches on for high heat.
4. When your room reaches the desired temperature, now slowly rotate the thermostat knob counter clockwise until the pilot light goes out. The thermostat can now be left at this setting. As soon as the room temperature has dropped below the set temperature, the unit will switch it self on automatically until the set temperature has been reached again. In this way the room temperature remains constant with the most economical use of electricity.
5. If you want to change the room temperature setting, rotate the thermostat knob clockwise to raise the temperature, or counter clockwise to lower it.
6. This heater includes an overheat protection system that shuts off the heater when parts of the heater are getting excessively hot.
7. To completely shut the heater off, turn all the controls to OFF, and remove plug from the socket-outlet.

MAINTENANCE

1. Always remove the plug from the socket-outlet and allow the radiator to cool down before cleaning the heater.
 2. Wipe radiator with a soft damp (not wet) cloth.
- WARNING:**
Do not immerse the heater in water.
Do not use any cleaning chemicals such as detergents and abrasives.
Do not allow the interior to get wet as this could create a hazard.
3. To store away the heater, wind the cable round bobbin and store the heater in a clean dry place.
 4. In case of malfunction or doubt, do not try to repair the radiator yourself, it may result in a fire hazard or electric shock.

CONFORMITY WITH DIRECTIVES

This product is CE marked to denote conformity with Directives 2014 /35/EU (Low Voltage) and the EMC directive (2014/30/EU), as amended.

Correct Disposal of this product

This marking indicates that this product should not be disposed with other household wastes throughout the EU. To prevent possible harm to the environment or human health from uncontrolled waste disposal, recycle it responsibly to promote the sustainable reuse of material resources. To return your used device, please use the return and collection systems or contact the retailer where the product was purchased. They can take this product for environmental safe recycling.

Information requirements for electric local space heaters

Model identifier(s): CR15/CR15T/CR2/CR2T/CR25

Item	Symbol	Value	Unit	Item	Unit
Heat output					
Type of heat input, for electric storage local space heaters only (select one)					
Nominal heat output	P _{nom}	0.7446/0.7446/0.8894/0.8894/0.9912	kW	manual heat charge control, with integrated thermostat	NA
Minimum heat output (indicative)	P _{min}	0	kW	manual heat charge control with room and/or outdoor temperature feedback	NA
Maximum continuous heat output	P _{max,c}	0.7446/0.7446/0.8894/0.8894/0.9912	kW	electronic heat charge control with room and/or outdoor temperature feedback	NA
Auxiliary electricity consumption				fan assisted heat output	NA
Type of heat output/room temperature control (select one)					
At nominal heat output	θ _{nom}	N/A	kW	with mechanic thermostat room temperature control	[yes]
At minimum heat output	θ _{min}	N/A	kW	with electronic room temperature control	[no]
In standby mode	θ _{st}	N/A	kW	electronic room temperature control plus day timer	[no]
				electronic room temperature control plus week timer	[no]
Other control options (multiple selections possible)					
				room temperature control, with presence detection	[no]
				room temperature control, with open window detection	[no]
				with distance control option	[no]
				with adaptive start control	[no]
				with working time limitation	[no]
				with black bulb sensor	[no]

Contact details: CED ELECTRICAL GROUP
44-48 Freshwater Road, Dagenham, Essex, RM8 1RX (England)