



Ergonomic features

- Slim keyboard and mouse designed to be portable
- 104 key UK layout with numeric pad on right
- responsive, low profile keys
- battery-powered keyboard and mouse
- automatic power saving sleep mode
- external silicone dust/splash cover
- plug-and-play, compatible with Windows XP and later
- symmetrical mouse designed for r/h or l/h use
- 3-button mouse with rubberised scroll wheel



Technical specifications

| | |
|------------------------|--------------------------------------------------------|
| Colours available | black |
| Keyboard weight & size | 308g / 385 x 110 x 20 mm |
| Mouse weight & size | 43g / 100 x 50 x 20 mm |
| Package weight & size | 463g / 460 x 120 x 35 mm |
| Batteries | 2 x AAA for keyboard, 1 x AAA for mouse (not included) |
| Product code | ST354120 |
| EAN | 0 601577 559108 |

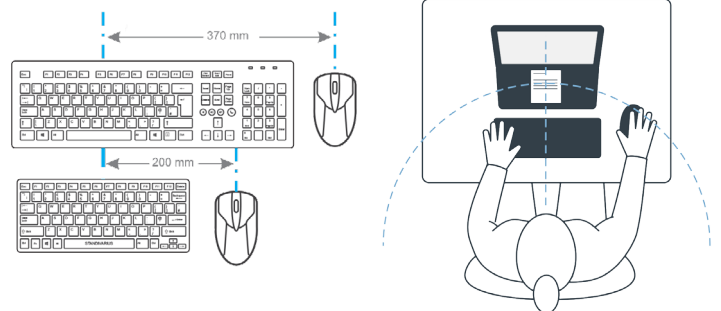

standivarius



standivarius
DMR Ergonomics SRL
Calea Circumvalatiunii nr 37 / 27
300671 Timisoara
Romania

UK: uk@standivarius.com / ++ 44 115 647 7406
Northern Europe (SE, FI, DK, NO) nordics@standivarius.com / ++46 10 551 6270
Benelux (B, NL, L): benelux@standivarius.com / ++40 723 014912
DACH (D, A, CH): dach@standivarius.com / ++40 728 160023
standivarius.com/aero-evo/Other:office@standivarius.com/ ++40 728 160023



standivarius.com