

WorkForce WF-7310DTW



DATASHEET / BROCHURE



Perfect for small businesses, the WF-7310DTW can print up to A3+, has dual paper trays, double-sided printing and has PrecisionCore printhead that produces high-quality, laser like prints

Get professional-looking prints quickly and without breaking the bank with the high quality, easy-to-use and compact WF-7310DTW printer. Its fast print speeds, dual paper trays plus rear paper tray ensure efficiency. Low cost hardware and affordable individual inks make this a low-cost solution for small businesses.

Professional A3+ printing

This compact and stylish A3+ printer will meet the needs of even the most demanding home and small office users. It can handle double-sided printing up to A3 and features two paper trays and a rear paper tray. Furthermore, its PrecisionCore printhead produces high-quality, laser-like prints.

Enhance your productivity

This efficient, reliable and fast model offers A3 double-sided printing and print speeds of 25ppm in black and 12ppm in colour*. It's simple to operate directly thanks to its easy-to-use 6.1cm LCD screen.

Minimise your outgoings

Dramatically reduce your costs with affordable replacement inks supplied individually, so you only replace the colour used. Giving great value for money, cartridges are available in standard, XL and XXL, with the highest yield delivering up to 2,200 pages*.

Flexible wireless solutions

Print from anywhere in the office with Wi-Fi connectivity or use Wi-Fi Direct to print from compatible wireless devices without a Wi-Fi network*. Plus, with Epson's Smart panel app you can control your printer from your device, printing documents, monitoring and troubleshooting*.

KEY FEATURES

- **High-quality A3+ printer for business quality documents**
Double-sided A3 printing and dual A3 paper trays
- **Wireless connectivity lets you print from anywhere**
Print and scan easily from your smartphone or tablet using the Epson iPrint app, for high-quality document printing*
- **Save money by only replacing the colour used**
With Epson's genuine individual inks
- **Print 25ppm in black and 12ppm in colour***
Breeze through your printing tasks with ease
- **User friendly 6.1cm LCD screen**
Easily navigate through the print options to complete your work efficiently
- **Legal Statement**
Complies with The UK Product Security and Telecommunications Infrastructure (Product Security) requirements. Epson will provide security updates for 7 years from purchase

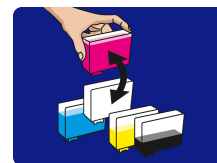

EPSON®

PRODUCT SPECIFICATIONS

TECHNOLOGY	
Printing Method	4-colour inkjet printer
Minimum Droplet Size	3.8 pl
Ink Technology	DURABrite™ Ultra
Nozzle Configuration	800 Nozzles Black, 256 Nozzles per Color
Category	Home Office, Office Desktop
All-in-One Functions	Print
PRINT	
Number of colours	4 colour
Printing Speed ISO/IEC 24734	25 pages/minMonochrome, 12 pages/minColour
Duplex Printing Speed ISO/IEC 24734	16 A4 Pages/minMonochrome, 9 A4 Pages/minColour
Maximum Printing Speed	32 pages/minMonochrome (plain paper 75 g/m²), 22 pages/minColour (plain paper 75 g/m²)
Printing Resolution	4,800 x 2,400 DPI
Recommended Duty Cycle	200 - 2,500 pages per month
Colours	Black [Pigment], Cyan [Pigment], Yellow [Pigment], Magenta [Pigment]
Print from	PC, MAC, Mobile Device
For detailed information on printing speeds please visit http://www.epson.eu/testing .	
PAPER / MEDIA HANDLING	
Paper Formats	A3+, A3 (29.7x42.0 cm), A4 (21.0x29.7 cm), A5 (14.8x21.0 cm), A6 (10.5x14.8 cm), B4, B5, C4 (Envelope), C6 (Envelope), DL (Envelope), No. 10 (Envelope), Letter, 9 x 13 cm, 10 x 15 cm, 13 x 18 cm, 16:9, User defined, Legal
Paper Tray Capacity	250 SheetsStandard
Number of paper trays	3
CONNECTIVITY	
Interfaces	Hi-Speed USB - compatible with USB 2.0 specification, Ethernet interface (100 Base-TX / 10 Base-T), Wireless LAN IEEE 802.11b/g/n, Wi-Fi Direct
WLAN Security	WEP 64 Bit, WEP 128 Bit, WPA PSK (TKIP)
GENERAL	
Energy Use	0.8 Watt(sleep mode), 26 Watt(Printing), 6.3 Watt(Ready), 0.2 Watt(Power off), TEC0.14 kWh/week
Product dimensions	515 x 400 x 298 mm (Width x Depth x Height)
Product weight	13.5 kg
Compatible Operating Systems	Mac OS X 10.11.x, Mac OS X 10.11.x or later, Mac OS X 10.12.x, Mac OS X 10.13.x, Mac OS X 10.6.8, Mac OS X 10.6.8 or later, Windows 10 (32/64 bit), Windows 7 (32/64 bit), Windows 8 (32/64 bit), Windows 8.1 (32/64 bit), Windows Server 2008 R2, Windows Server 2012 R2, Windows Server 2016, Windows Vista (32/64 bit), Windows XP Professional x64 Edition SP2 or later, Windows XP SP3 or later (32-bit), Windows Server 2003 R2
ADDITIONAL FEATURES	
Panel	Type: Color, Diagonal:6.1 cm
OTHER	
Warranty	12 months On-site service Optional warranty extension available

LOGISTICS INFORMATION

SKU	C11CH70401
EAN code	8715946690698
Country of Origin	Indonesia

WorkForce WF-7310DTW

WHAT'S IN THE BOX

- Driver and Utilities (CD)
- Individual Ink Cartridges
- Main unit
- Power Code
- Quick Start Guide
- Warranty Documents

INK CARTRIDGE COMPATIBILITY

● 405

● 405

● 405

● 405

● 405

● 405



INK YIELD DATA

	Suitcase 405	Suitcase 405XL
	<div><div>●</div><div>●</div><div>●</div></div> 350 pages*1,100 pages*	<div><div>●</div><div>●</div><div>●</div></div> 300 pages*1,100 pages*

* Approx. page yield based on ISO/IEC 24711/24712 or ISO/IEC 29102/29103. Actual yield will vary depending on images printed and usage conditions. For more information visit <http://www.epson.eu/pageyield>

For more information please contact:

Home users: 0343 90 37766
Business users*: 0871 42 37766
Republic of Ireland: 01 436 7742
Or visit us at <https://www.epson.co.uk/contactus>
* 10p per minute plus network extras.

Web: www.epson.co.uk
www.epson.ie

1. see epson.co.uk/cartridgefootnotes



Trademarks and registered trademarks are the property of Seiko Epson Corporation or their respective owners.
Product information is subject to change without prior notice.
Last extracted: 2024-11-07