



User Guide

Tapo Smart Wi-Fi Light Bulb

Contents

| | |
|---|----|
| About This Guide | 1 |
| Introduction | 2 |
| Set Up Your Smart Bulb | 4 |
| Work with Amazon Alexa & Google Assistant | 6 |
| Basic Device Control | 7 |
| Configure Your Smart Bulb | 8 |
| Smart Actions | 11 |
| Share Your Smart Bulb | 13 |
| Reset Your Smart Bulb | 14 |
| Amazon Frustration-Free Setup (FFS) | 15 |
| Authentication | 20 |

About This Guide

This guide provides a brief introduction to the Tapo Smart Wi-Fi Light Bulb and the Tapo app, as well as regulatory information.

Features available in Tapo may vary by model and software version. Tapo availability may also vary by region. All images, steps, and descriptions in this guide are only examples and may not reflect your actual Tapo experience.

Conventions

In this guide, the following convention is used:

| Convention | Description |
|---|--|
| Blue | Key information appears in teal, including management page text such as menus, items, buttons and so on. |
| <u>Underline</u> | Hyperlinks are in teal and underlined. You can click to redirect to a website. |
|  Note: | Ignoring this type of note might result in a malfunction or damage to the device. |

More Info

- Specifications can be found on the product page at <https://www.tapo.com>.
- Our Technical Support and troubleshooting information can be found at <https://www.tapo.com/support/>.
- A Technical Community is provided for you to discuss our products at <https://community.tp-link.com>.
- Setup and Reset Video can be found at <https://www.tp-link.com/support/setup-video/>.

Introduction

The Tapo smart Wi-Fi light bulb is part of the Tapo smart home family of products, including plugs, switches, cameras and more. Smart Bulb lets you easily control your lights via the Tapo app, no matter where you find yourself. You can adjust brightness, set schedules and timers, and use the Fade On feature to wake you up naturally and Fade Off for a peaceful sleep. Group lights together to control your smart bulbs more easily.

| Tapo L510 Series (Dimmable) Dimming range from 1%-100%, lighting for any occasion | TL13E/Tapo L530 Series/L531E/ (Multicolor) Multicolor and easy dimming for perfect ambiance | Tapo L520E (Daylight) Dimmable with comfortable daylight 4000K |
|---|---|--|
|  |  |  |
|  |  |  |

*Images may differ from actual products due to different regional specifications.

Features

- **No Hub Required** - Connect to your existing Wi-Fi router.
- **Remote Control** - Instantly turn the light on/off wherever you are through the Tapo app.
- **Schedule** - Use Schedules to set your light to automatically turn on and off.
- **Timer** - Set a countdown timer to automatically turn the light on or off after a certain amount of time.
- **Preset for Convenience** - Save and preset your favorite lightings for multiple scenarios.
- **Sunrise and Sunset Mode** - Automatically activate your bulb according to your time zone.
- **Away Mode** - Set a period of time during which the light will be randomly turned on and off to make it look like you're home.
- **Energy Saving** - Reduce energy use up to 85% without losing brightness or quality.
- **Restore Last Light State** - The bulb automatically returns to its previous power-off state.
- **Device Sharing** - Invite your family members to manage the bulb together.
- **Voice Control** - Use Amazon Alexa, Google Assistant or SmartThings to control your bulb with voice commands.*

*Voice assistants may vary from product models.

Set Up Your Smart Bulb

Follow the steps below to get started with your new smart bulb. Setup videos can be found at <https://www.tp-link.com/support/setup-video/>.

Step 1. Download Tapo App

Get the [Tapo](#) app from the App Store or Google Play, or by scanning the QR code below.



OR



Step 2. Log In

Open the app, and log in with your TP-Link ID. If you don't have an account, tap [Sign Up](#) to create one first.

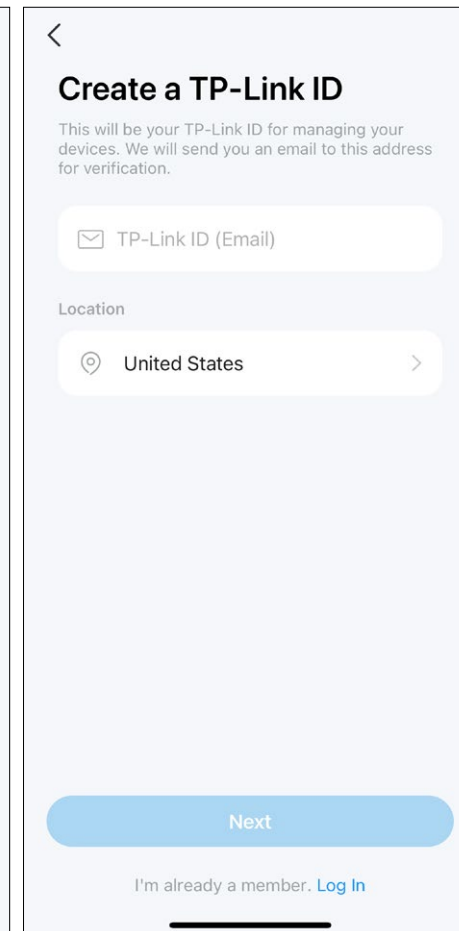
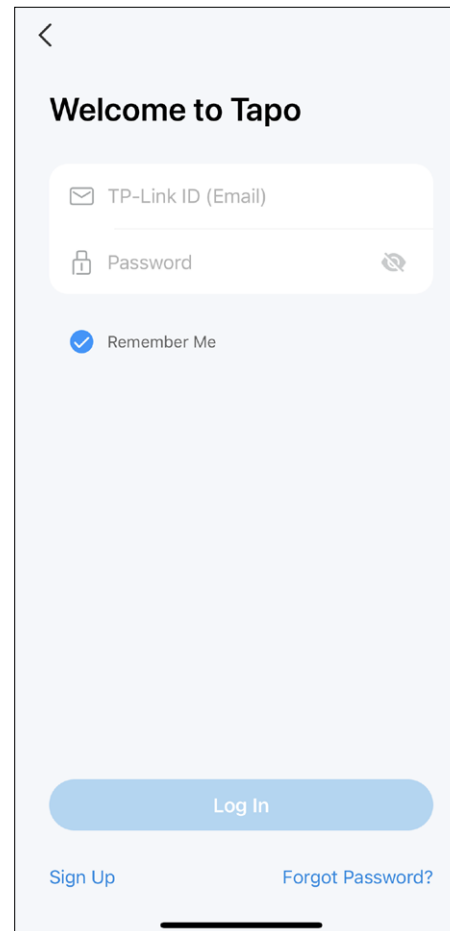

Step 3. Add Your Smart Bulb

Tap the ⊕ button in the app and select [Add Device](#). Select [Lights](#) and then your model. Follow app instructions to set up your smart bulb, and add it to your home network.

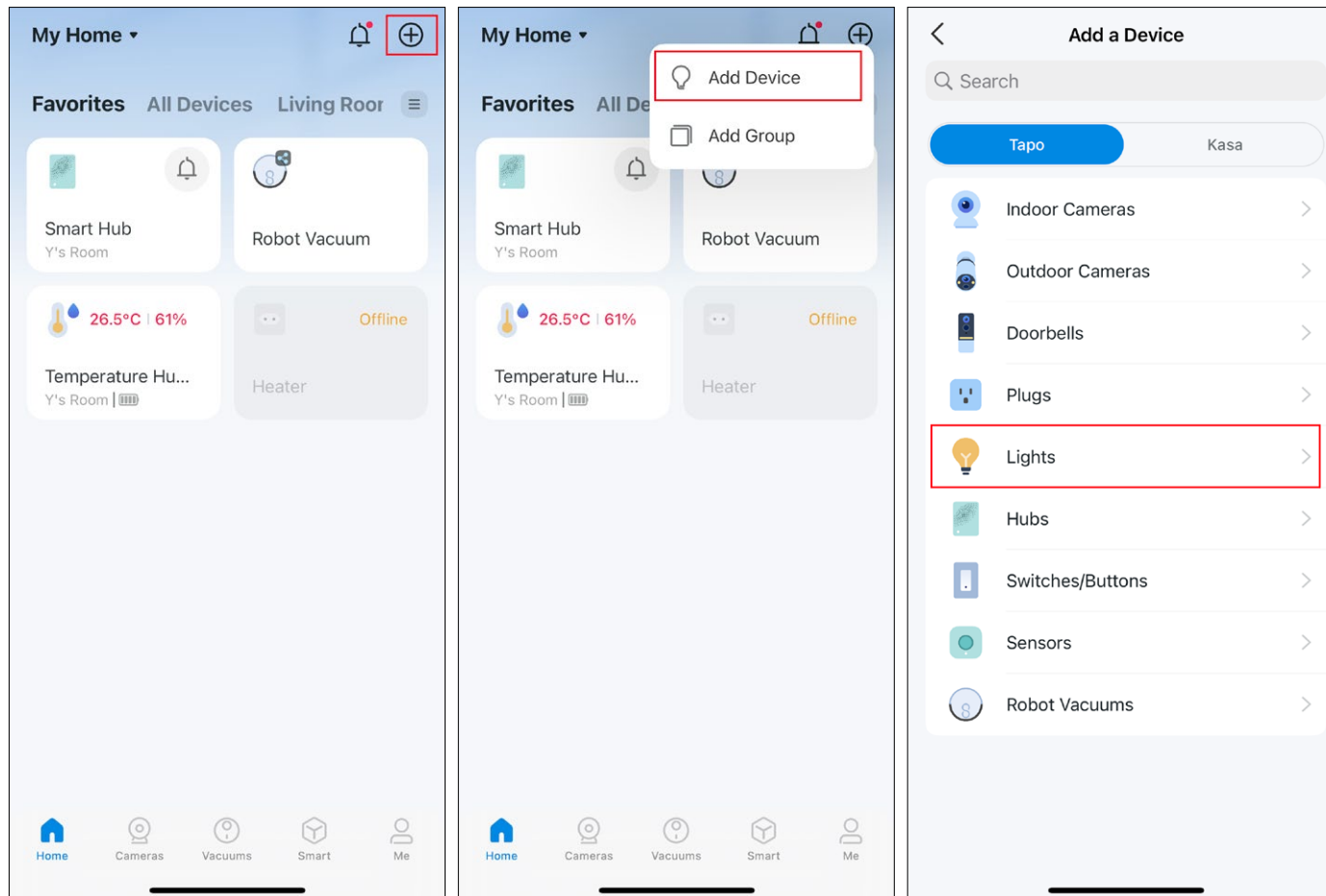

Work with Amazon Alexa & Google Assistant

After set up your smart bulbs on the Tapo app, you can connect Tapo to Amazon Alexa or Google Assistant to voice control your smart bulbs.

■ Note: Make sure your Tapo smart bulbs are successfully set up on the Tapo app and are online.

Launch the Tapo app. Go to the Me page and tap **Third-Party Services**. Choose **Amazon Alexa** or **Google Assistant** and follow the app instructions to complete the connection.

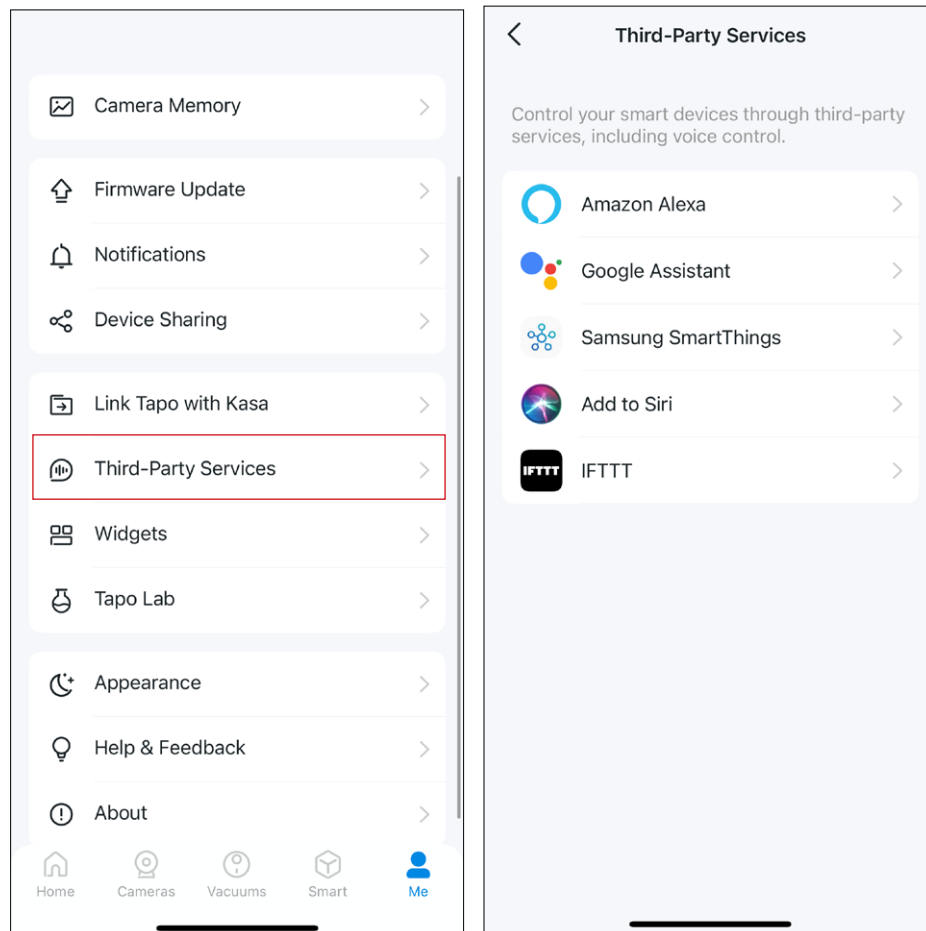

Basic Device Control

After successfully setting up your smart bulb, you will see the home page of the Tapo app. Here you can view the status of all devices that you've added and manage them. You can tap on the device to control and manage.

■ Note: Only multi-color bulbs support color-related and Auto White features. Here we take the Tapo L530E as an example.

Home Page

You can turn on or off the bulb anywhere and tap the bulb card to enter the status page.

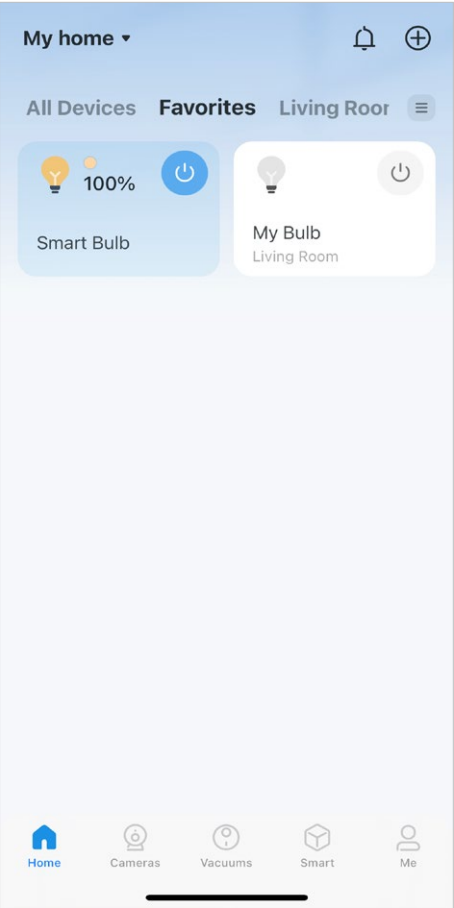

Device Status Page

You can adjust colors and temperature, enjoy main features to control your device, and view its runtime & energy usage.

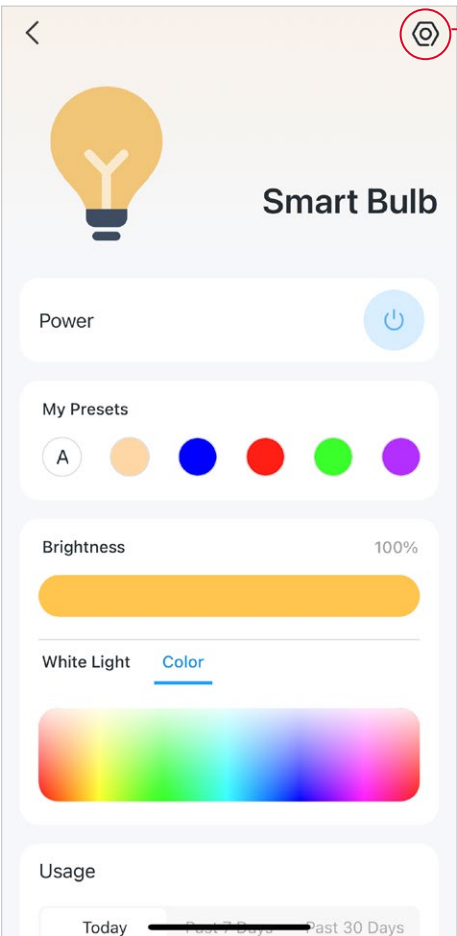

Device Settings Page

You can edit the basic information, set Last On State, enable gentle on/off, add a group, update firmware and more.

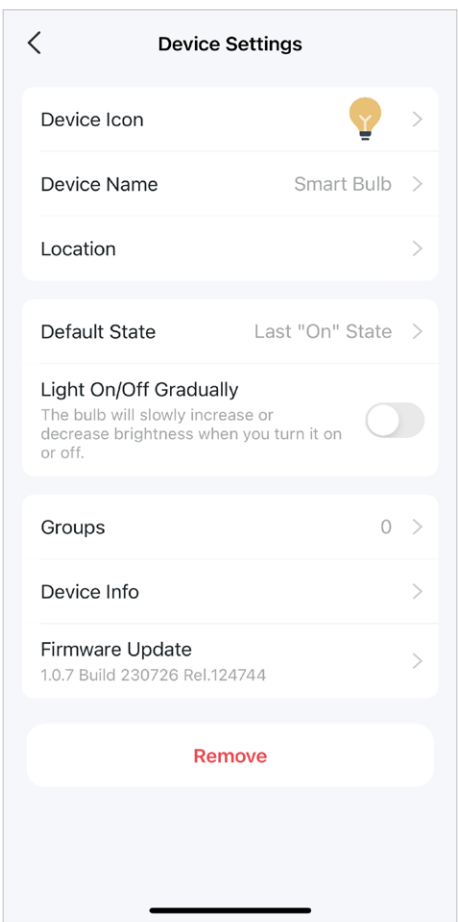

Configure Your Smart Bulb

You can configure your smart bulb by adjusting lighting settings and setting Themes, Presets, Auto White, Schedule, Timer, Away Mode and more.

■ Note: Only multi-color bulbs support color-related and Auto White features. Here we take the Tapo L530E as an example.

Turn On/Off

Tap the power button to turn the bulb on or off.

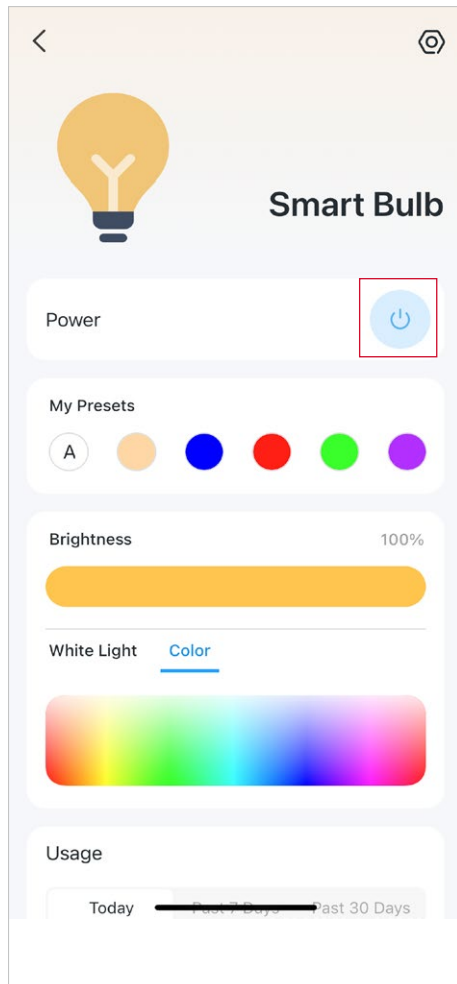

Set Presets

With Presets, you can quickly apply your favourite preset at one tap. To edit preset, just select one and tap edit.

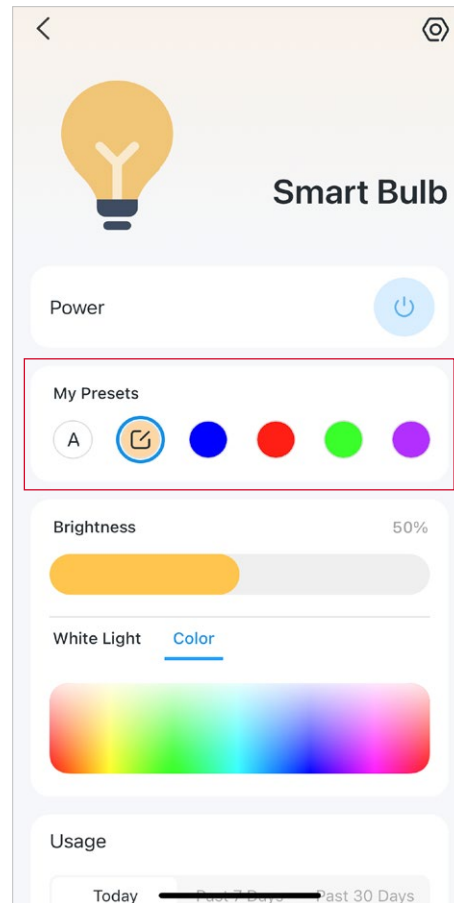

Enable Auto White

Tap **A** under "My Presets" to select a lighting option (Auto Compensate or Auto Match) for your bulb. And the bulb will adjust color temperature or brightness as the ambient lighting throughout the day.

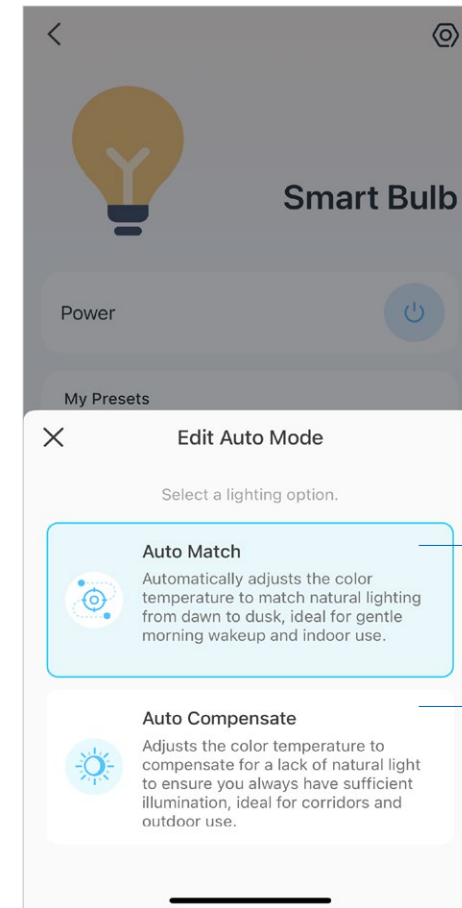

Note: Only multi-color bulbs support color-related and Auto White features. Here we take the Tapo L530E as an example.

Main Features

On the device status page, you can use the Theme, Schedule, Timer, and Away Mode features.

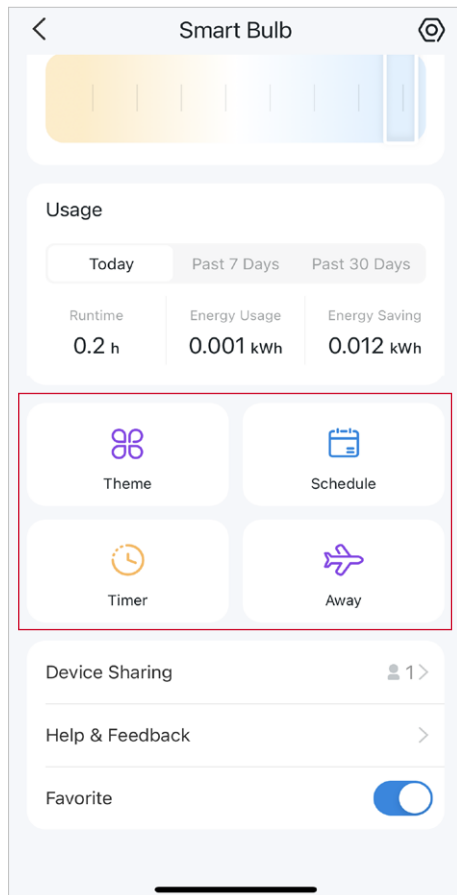

Set Theme

Tap [Theme](#) to apply theme to your bulb to fit your home atmosphere. You can custom shift style, speed, and color cycle yourself.

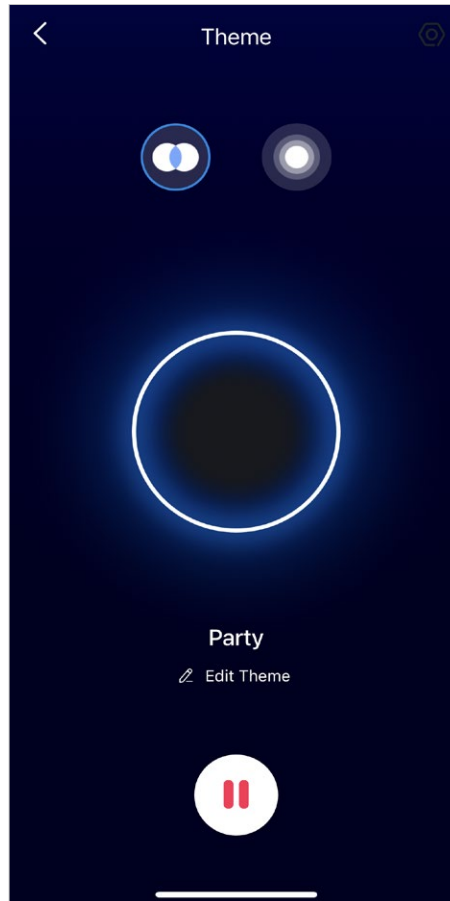

Set Schedule

Tap [Schedule](#) to add a schedule for your bulb to automatically turn on/off and adjust the lighting settings to simplify your daily routine.

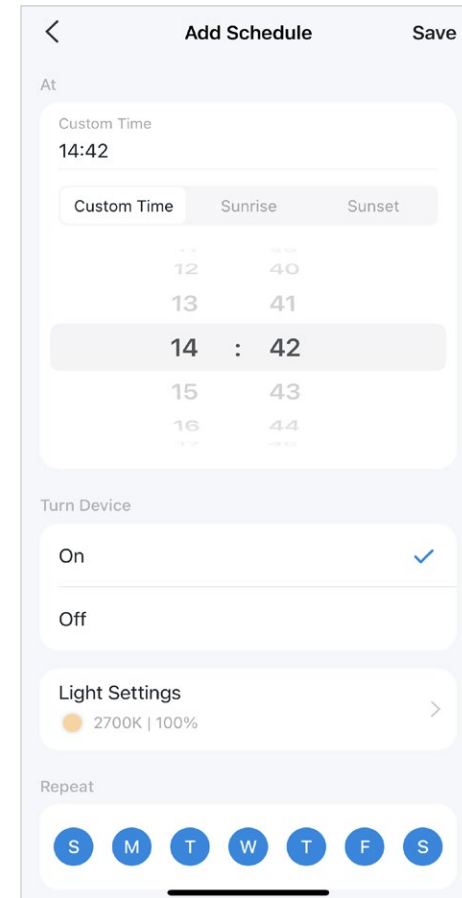

Set Timer

Tap [Timer](#) to set the timer and lighting settings, then your bulb will automatically turn on with the specific settings after the timer ends.

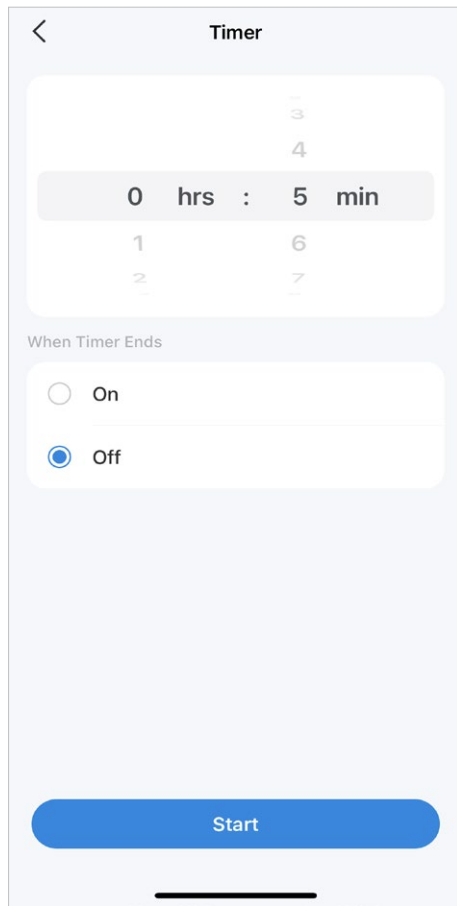

Set Away Mode

Tap [Away](#) to preset the Away Mode, set the start and end time, then your bulb will be randomly turned on/off during this period.

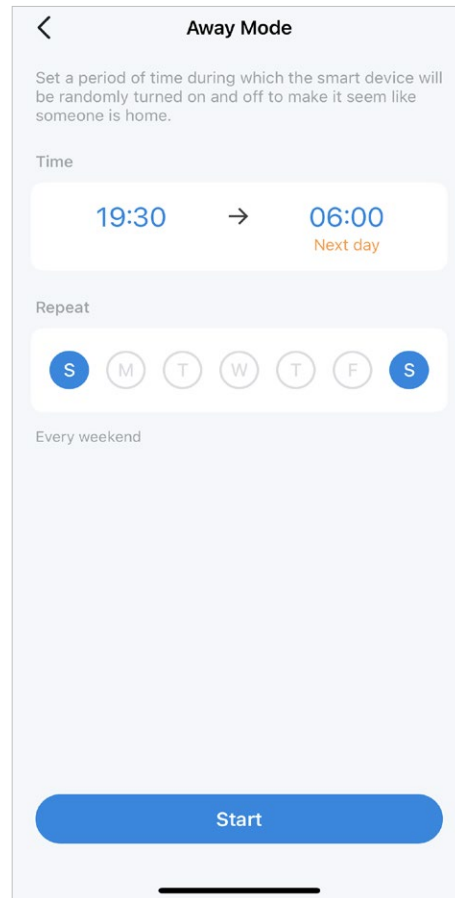

Check Runtime & Energy Usage

Slide up to check your bulb's Runtime and Energy Usage today, past 7 days or past 30 days.

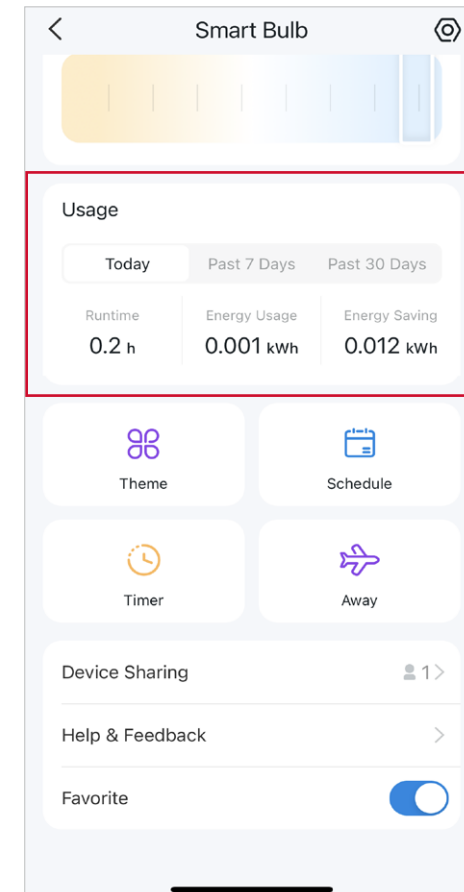

Smart Actions

Smart Actions automate repetitive tasks, allowing you to blaze through tedium with utmost ease. Set everything up once and never have to worry about it again. With Smart Actions, giving your home that level of intelligence is a snap. Shortcut lets you perform an action with a simple tap. Automation allows you to automate tasks to be performed at a set time. e.g. The light will light on at sunset.

Option 1: Edit based on the featured actions

1. Go to the [Smart Actions](#) page and you will see the [Featured Actions](#) (Shortcut or Automation).

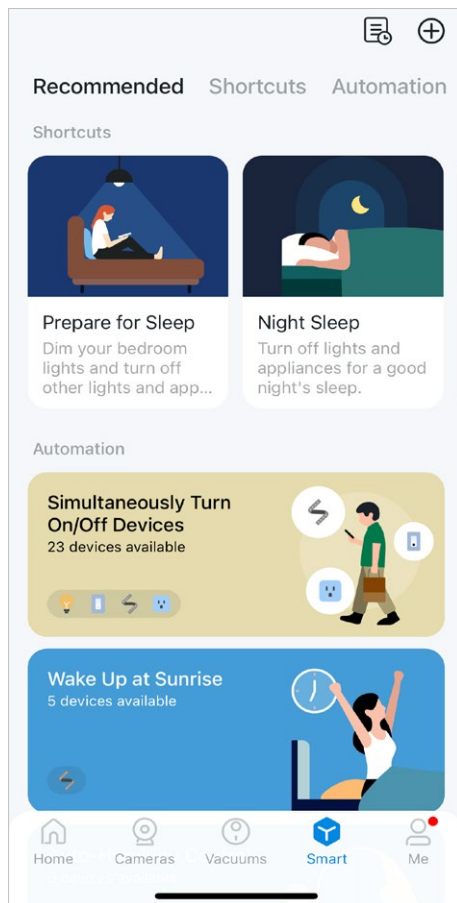

2. Tap on a featured action. Tap [EDIT](#) to change the settings as needed and tap [ADD](#) to save changes.

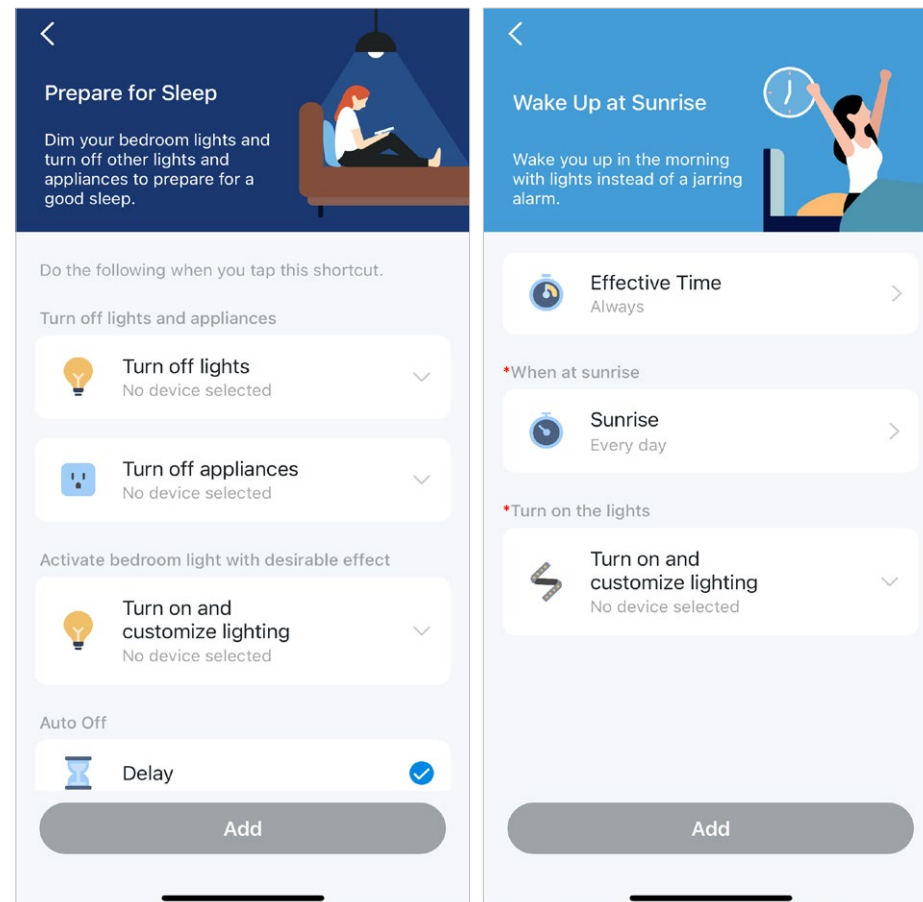

Option 2: Create your own smart actions

1. Go to [Smart](#) page. Tap + on the top right to add a simple and smart action.

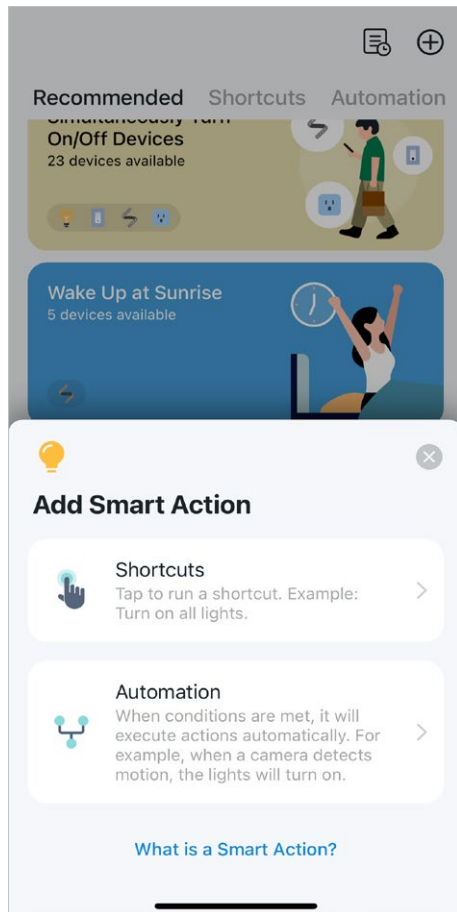

2. For Shortcuts: Tap + to add action like turning on the smart bulb.

For Automation: Tap + to add triggers (*When*) like the trigger time, tap + to add conditions (*If*), and tap + to add action (*Then*) like turning on the smart bulb.

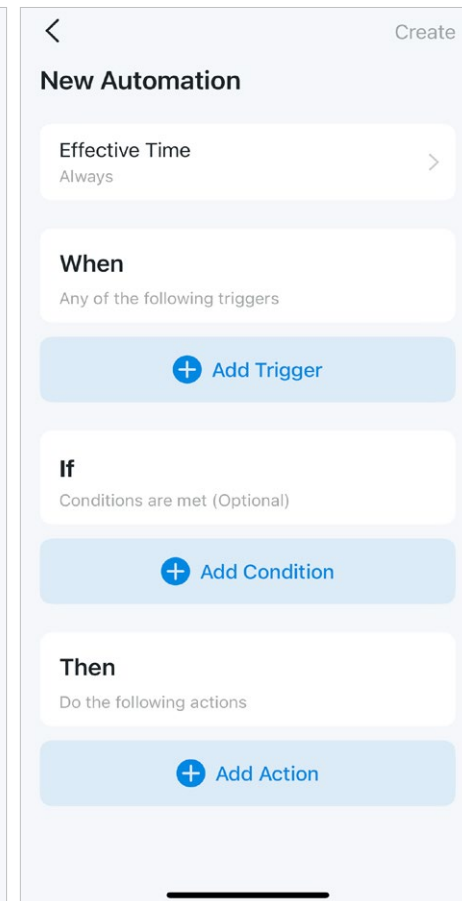
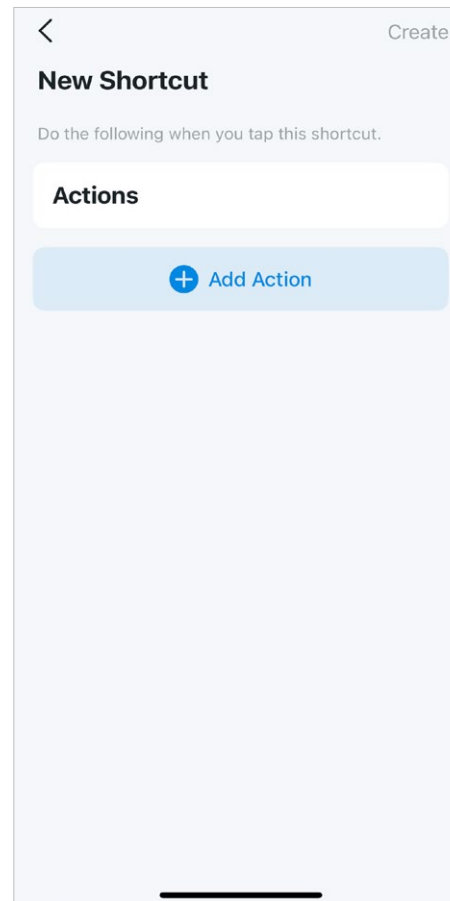

Share Your Smart Bulb

You can invite your family members to manage your Tapo devices together by entering the TP-Link ID (email) you want to share the devices with.

Method 1

On the home page, long press the bulb card and tap [Share](#).

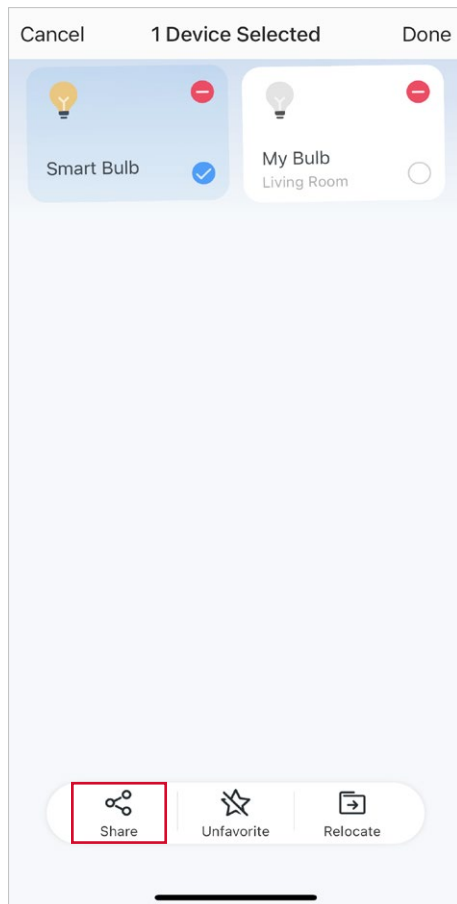

Method 2

Go to [Device Status](#) page, slide up and tap [Device Sharing](#).

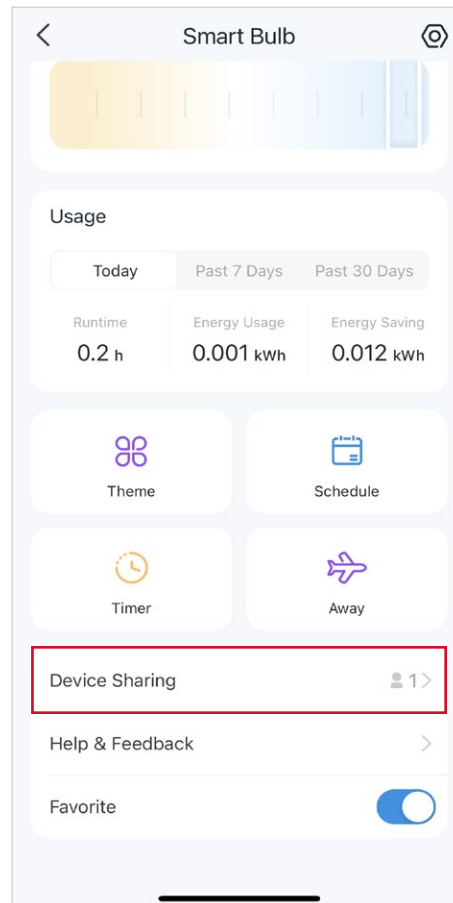

Method 3

Go to [Me](#) page and tap [Device Sharing](#) to view your shared devices and devices shared from others.

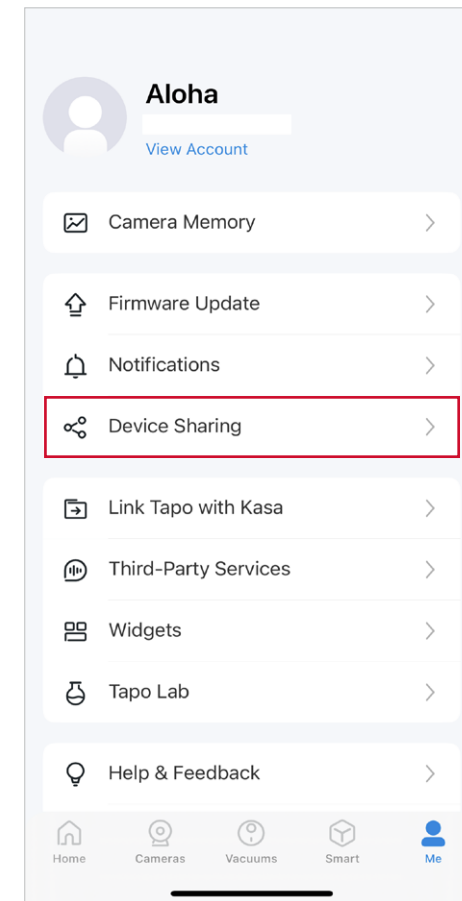

Reset Your Smart Bulb

There are two types of reset available: a [soft reset](#) which resets the Wi-Fi settings only, and a [factory reset](#) that erases all of your custom settings and restore them to factory defaults.

Soft Reset (without losing the configuration settings except Wi-Fi)

1. Turn the light switch controlling the smart bulb to the on position first.
2. Switch it off and on **3** times, pausing for two seconds in between.
3. Wait for about 4 seconds and the smart bulb should blink 3 times, which indicates a successful soft reset.

Factory Reset (back to factory default settings)

Method 1

1. Turn the light switch controlling the smart bulb to the on position first.
2. Switch it off and on **5** times, pausing for two seconds in between.
3. Wait for about 4 seconds and the smart bulb should blink 3 times, which indicates a successful soft reset.

Method 2

On the home page in Tapo app, long press the card and tap [Remove](#). **OR** Go to bulb's Settings page and tap [REMOVE](#) at the bottom.

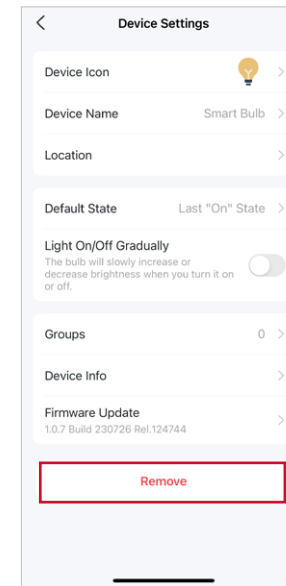
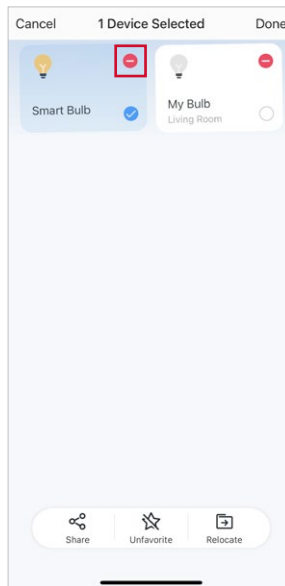

Amazon Frustration-Free Setup (FFS)

■ Note: Only for smart bulbs that support Amazon Frustration-Free Setup.

What is Amazon Frustration-Free Setup (FFS)?

Amazon Frustration-Free Setup can help connect and set up Tapo smart devices in fewer steps, without having to remember and re-enter your Wi-Fi password on each device.

To use this feature, confirm the following:

- The device is purchased from Amazon and tick "Link to your Alexa account and to Tapo to simplify setup" at checkout.
- The new Tapo device supports FFS.
- You have an FFS enabled Alexa device or router.
- You have saved your Wi-Fi information to Amazon by using Alexa echo.
- Your Tapo device and router are on the same network as your Alexa echo.

LED Indications during Amazon Frustration-Free Setup

| LED | Status |
|----------------------------|---|
| Solid white | Ready for setup |
| Blinking white twice | FFS setup in progress |
| Blinking white three times | FFS setup failed and you can manually set up the bulb from the app manually |

Simple Setup with Echo Device

STEP 1

- Make sure to first set up your Echo device.

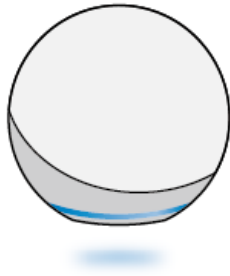

STEP 2

- Power on your smart bulb and get close to echo. Go to Step 3 if your Echo or Alexa app notifies "First light found".
- Otherwise, refer to the troubleshooting guide.



STEP 3

- Once you've completed setup, you can use your smart bulb with Alexa. Just say "Alexa, set first light to blue".



Troubleshooting Guide

Follow the steps below to manually set up your smart bulb and enable Alexa voice control.

1. Manual Bulb Setup via The Tapo App

Open the Tapo app and tap the + icon to start the manual setup process.

2. Linking Tapo to Alexa

On your Tapo app, go to [Me > Third-Party Services](#), select [Amazon Alexa](#), and follow the app guidance to complete the connection.

For detailed connection instructions, please refer to:
<https://www.tp-link.com/support/faq/2780/>



For technical support, user guide download, and more, please visit www.tapo.com/support/



Set Up via the Alexa App

1. Open the Amazon Alexa app. Then tap **More** and select **Skills & Games**.

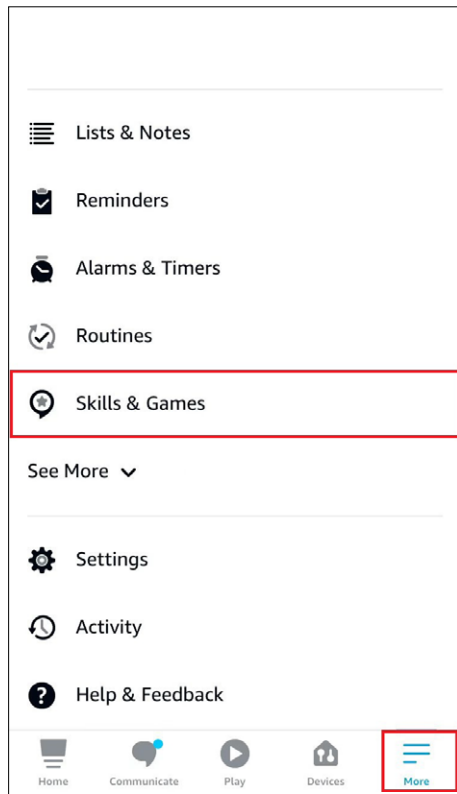

2. Enter **Tapo** in the search bar and choose **Tapo**.

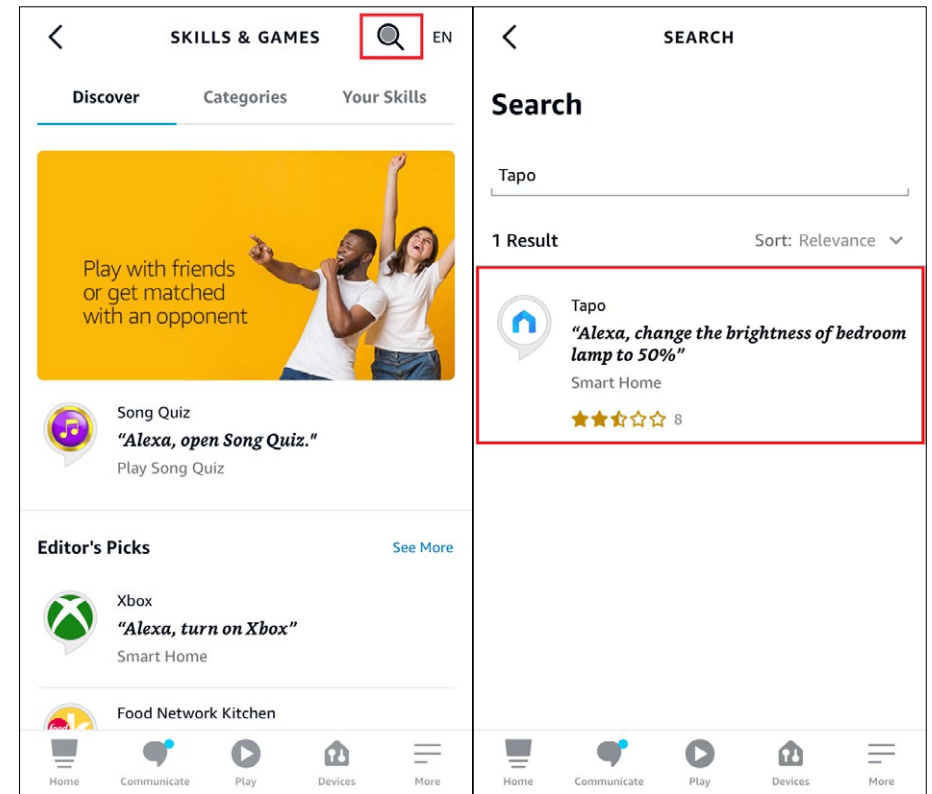

3. Tap the **ENABLE TO USE** button.

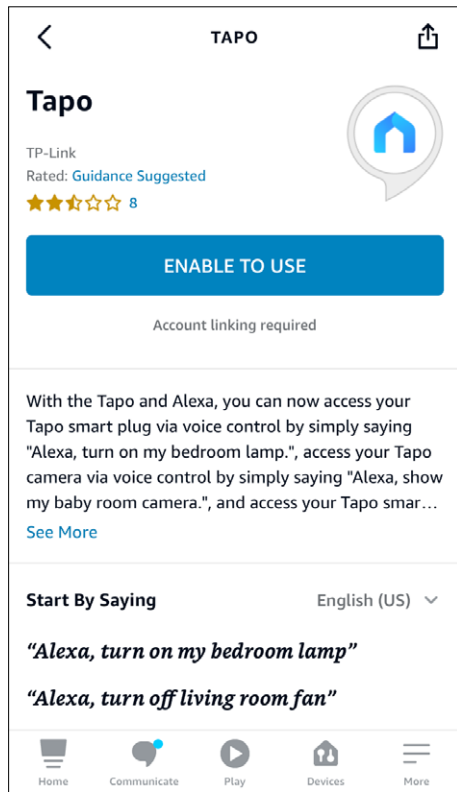

4. Log in with your TP-Link ID that has bound to your Tapo device, and tap **Authorize**. After authorized successfully, the message **Tapo has been successfully linked** will come up.

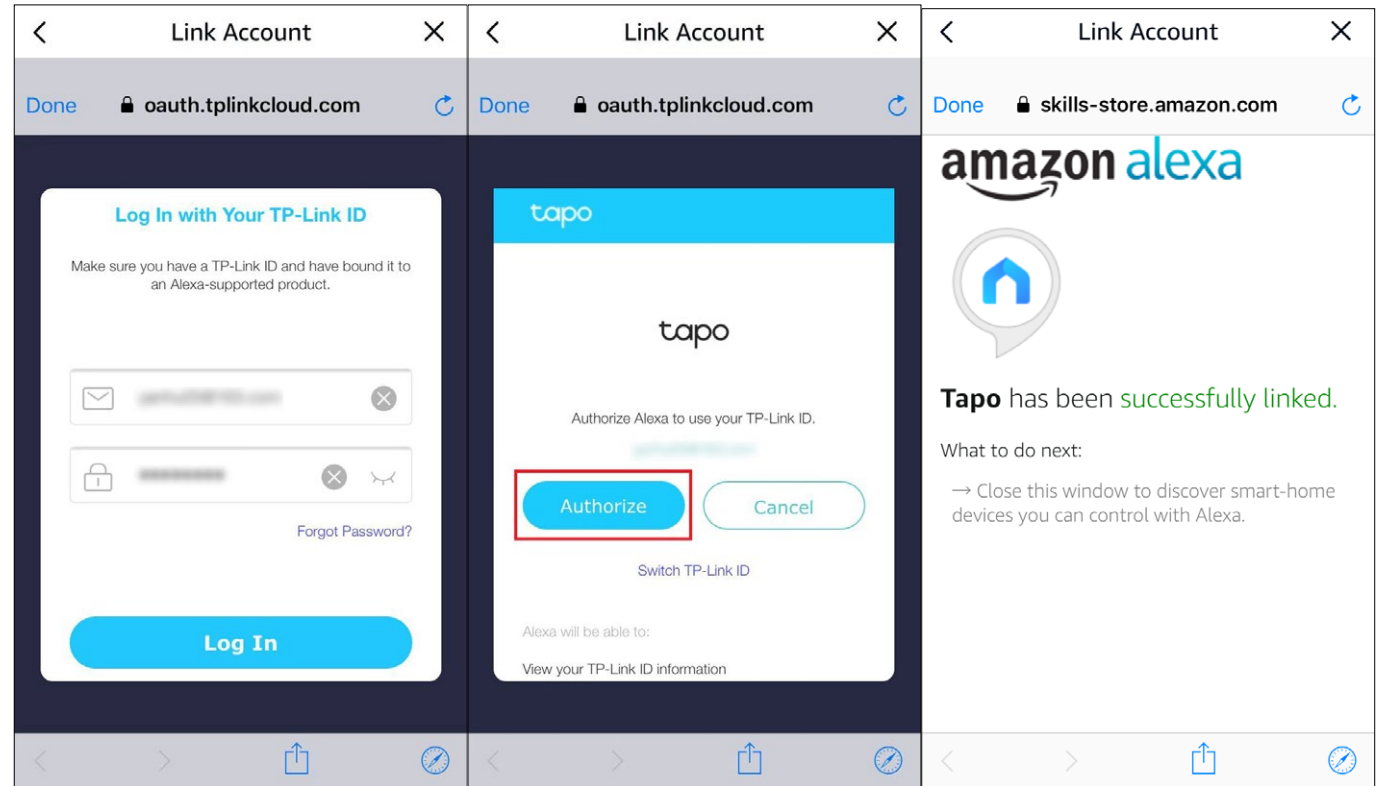

5. Power up your Tapo device and the setup will complete automatically in two minutes.

For setting up more Tapo devices, just power up and enjoy!

Done!

If this device displays on the Home page in the Tapo app, it indicates this device has been successfully associated with your Amazon account and joined your Wi-Fi network automatically.

If this device does not display on the Home page in the Tapo app, try setting it up manually. (Tap the + button on the page, select your device model, and then follow the app instructions to complete setup.)

Authentication

FCC Compliance Information Statement



Product Name: Tapo Smart Wi-Fi Light Bulb

Model Number: TL13E/Tapo L510E/Tapo L520E/Tapo L530E/Tapo L531E

Responsible party:

TP-Link USA Corporation

Address: 10 Mauchly, Irvine, CA 92618

Website: <http://www.tp-link.com/us/>

Tel: +1 626 333 0234

Fax: +1 909 527 6804

E-mail: sales.usa@tp-link.com

This equipment has been tested and found to comply with the limits for a Class B digital device, pursuant to part 15 of the FCC Rules. These limits are designed to provide reasonable protection against harmful interference in a residential installation. This equipment generates, uses and can radiate radio frequency energy and, if not installed and used in accordance with the instructions, may cause harmful interference to radio communications. However, there is no guarantee that interference will not occur in a particular installation. If this equipment does cause harmful interference to radio or television reception, which can be determined by turning the equipment off and on, the user is encouraged to try to correct the interference by one or more of the following measures:

- Increase the separation between the equipment and receiver.
- Reorient or relocate the receiving antenna.
- Connect the equipment into an outlet on a circuit different from that to which the receiver is connected.
- Consult the dealer or an experienced radio/ TV technician for help.

This device complies with part 15 of the FCC Rules. Operation is subject to the following two conditions:

1. This device may not cause harmful interference.
2. This device must accept any interference received, including interference that may cause undesired operation.

Any changes or modifications not expressly approved by the party responsible for compliance could void the user's authority to operate the equipment.

Note: The manufacturer is not responsible for any radio or TV interference caused by unauthorized modifications to this equipment. Such modifications could void the user's authority to operate the equipment.

FCC RF Radiation Exposure Statement

This equipment complies with FCC RF radiation exposure limits set forth for an uncontrolled environment. This device and its antenna must not be co-located or operating in conjunction with any other antenna or transmitter.

"To comply with FCC RF exposure compliance requirements, this grant is applicable to only Mobile Configurations. The antennas used for this transmitter must be installed to provide a separation distance of at least 20 cm from all persons and must not be co-located or operating in conjunction with any other antenna or transmitter."

We, **TP-Link USA Corporation**, has determined that the equipment shown as above has been shown to comply with the applicable technical standards, FCC part 15. There is no unauthorized change is made in the equipment and the equipment is properly maintained and operated.

Issue Date: 2024.6.28

CE Mark Warning



This is a class B product. In a domestic environment, this product may cause radio interference, in which case the user may be required to take adequate measures.

Operating Frequency

2400 MHz -2483.5 MHz (20dBm)

EU declaration of conformity

TP-Link hereby declares that the device is in compliance with the essential requirements and other relevant provisions of directives 2014/53/EU, 2009/125/EC, 2011/65/EU, and (EU)2015/863.

The original EU declaration of conformity may be found at <https://www.tapo.com/support/ce/>

RF Exposure Information

This device meets the EU requirements (2014/53/EU Article 3.1a) on the limitation of exposure of the general public to electromagnetic fields by way of health protection.

The device complies with RF specifications when the device used at 20 cm from your body.

Restricted to indoor use.



UK declaration of conformity

TP-Link hereby declares that the device is in compliance with the essential requirements and other relevant provisions of the Radio Equipment Regulations 2017.

The original UK declaration of conformity may be found at <https://www.tapo.com/support/ukca/>



Продукт сертифіковано згідно с правилами системи УкрСЕПРО на відповідність вимогам нормативних документів та вимогам,

що передбачені чинними законодавчими актами України.



Canadian Compliance Statement

This device complies with Industry Canada license-exempt RSSs. Operation is subject to the following two conditions:

- 1) This device may not cause interference, and
- 2) This device must accept any interference, including interference that may cause undesired operation of the device.

Le présent appareil est conforme aux CNR d'Industrie Canada applicables aux appareils radio exempts de licence. L'exploitation est autorisée aux deux conditions suivantes :

- 1) l'appareil ne doit pas produire de brouillage;
- 2) l'utilisateur de l'appareil doit accepter tout brouillage radioélectrique subi, même si le brouillage est susceptible d'en compromettre le fonctionnement.

Radiation Exposure Statement:

This equipment complies with IC radiation exposure limits set forth for an uncontrolled environment. This equipment should be installed and operated with minimum distance 20cm between the radiator & your body.

Déclaration d'exposition aux radiations:

Cet équipement est conforme aux limites d'exposition aux rayonnements IC établies pour un environnement non contrôlé. Cet équipement doit être installé et utilisé avec un minimum de 20 cm de distance entre la source de rayonnement et votre corps.

Industry Canada Statement

CAN ICES-3 (B)/NMB-3(B)

CAN ICES-005(B)/NMB-005(B)

NCC Notice

注意!

取得審驗證明之低功率射頻器材，非經核准，公司、商號或使用者均不得擅自變更頻率、加大功率或變更原設計之特性及功能。

低功率射頻器材之使用不得影響飛航安全及干擾合法通信；經發現有干擾現象時，應立即停用，並改善至無干擾時方得繼續使用。

前述合法通信，指依電信管理法規定作業之無線電通信。

低功率射頻器材須忍受合法通信或工業、科學及醫療用電波輻射性電機設備之干擾。

BSMI Notice

安全諮詢及注意事項

- 請使用原裝電源供應器或只能按照本產品注明的電源類型使用本產品。
- 清潔本產品之前請先拔掉電源線。請勿使用液體、噴霧清潔劑或濕布進行清潔。
- 注意防潮，請勿將水或其他液體潑灑到本產品上。
- 插槽與開口供通風使用，以確保本產品的操作可靠並防止過熱，請勿堵塞或覆蓋開口。
- 請勿將本產品置放於靠近熱源的地方。除非有正常的通風，否則不可放在密閉位置中。
- 不要私自拆開機殼或自行維修，如產品有故障請與原廠或代理商聯繫。

限用物質含有情況標示聲明書

| | | | | | | |
|----------------------------------|--|----------------------|----------------------|--|--|---|
| 設備名稱：Tapo Smart Wi-Fi Light Bulb | | | | 型號（型式）：TL13E/Tapo L510E/Tapo L520E/Tapo L530E/Tapo L531E | | |
| Equipment name | | | | Type designation (Type) | | |
| 單元 Unit | 限用物質及其化學符號 Restricted substances and its chemical symbols | | | | | |
| | 鉛 Lead (Pb) | 汞 Mercury (Hg) | 鎘 Cadmium (Cd) | 六價鉻 Hexavalent chromium (Cr ⁺⁶) | 多溴聯苯 Polybrominated biphenyls (PBB) | 多溴二苯醚 Polybrominated diphenyl ethers (PBDE) |
| PCB | ○ | ○ | ○ | ○ | ○ | ○ |
| 外殼 | ○ | ○ | ○ | ○ | ○ | ○ |
| 電源供應板 | — | ○ | ○ | ○ | ○ | ○ |
| 其他及其配件 | — | ○ | ○ | ○ | ○ | ○ |

備考1. “超出0.1 wt %” 及 “超出0.01 wt %” 係指限用物質之百分比含量超出百分比含量基準值

Note 1: “Exceeding 0.1 wt %” and “exceeding 0.01 wt %” indicate that the percentage content of the restricted substance exceeds the reference percentage value of presence condition.

備考2. “○” 係指該項限用物質之百分比含量未超出百分比含量基準值。

Note 2: “○” indicates that the percentage content of the restricted substance does not exceed the percentage of reference value of presence.

備考3. “—” 係指該項限用物質為排除項目。

Note 3: The “—” indicates that the restricted substance corresponds to the exemption.

Safety Information

- Keep the device away from water, fire, humidity or hot environments.
- Do not attempt to disassemble, repair, or modify the device.
- Do not use the device where wireless devices are not allowed.
- Only use the control provided with or specified by these instructions to control this device.
- For lamps with a weight significantly higher than that of the lamps for which they are a replacement, attention should be drawn to the fact that the increased weight may reduce the mechanical stability of certain luminaires and lampholders and may impair contact making and lamp retention.











WARNING:













- RISK OF ELECTRIC SHOCK OR BURNS. Switch OFF the light switch controlling the bulb and WAIT for the bulb to cool down before attempting to change it.
- Do not install the Smart Bulb with wet hands or when standing on wet or damp surfaces.
- Compatible with regular light switches. Not suitable for use with standard in-wall dimmers. Not compatible with photosensors, motion sensors, or timers. Dimmable via the app only.
- NOT for use in totally enclosed or recessed luminaires. Suitable for damp locations.
- NOT FOR EMERGENCY LIGHTING.
- The increased weight may reduce the mechanical stability of certain luminaires and lampholders and may impair contact making and lamp retention.
- Please read and follow the above safety information when operating the device. We cannot guarantee that no accidents or damage will occur due to improper use of the device. Please use this product with care and operate at your own risk.
- Operating Temperature: 0°C~40°C(32°F~104°F)



- Storage Temperature: -20°C~70°C(-4°F-158°F)
- Operating Humidity: 10%~90%RH, Non-condensing
- Storage Humidity: 10%~90%RH, Non-condensing

Explanation of the symbols on the product label

Symbols may vary from products

| Symbol | Explanation |
|---|---|
|  | Class II equipment |
|  | Class II equipment with functional earthing |
|  | Dimming not allowed |
|  | Lamp not suitable for use under moisture |
|  | Alternating current |
|  | DC voltage |
|  | Polarity of output terminals |
|  | Indoor use only |
|  | Dangerous voltage |
|  | Caution, risk of electric shock |

| Symbol | Explanation |
|---|---------------------------|
|  | Energy efficiency Marking |
|  | Protective earth |
|  | Earth |
|  | Frame or chassis |
|  | Functional earthing |
|  | Caution, hot surface |
|  | Caution |
|  | Operator's manual |
|  | Stand-by |
|  | "ON"/"OFF" (push-push) |
|  | Fuse |
|  | Fuse is used in neutral N |

| Symbol | Explanation |
|---|--|
|  | <p>RECYCLING</p> <p>This product bears the selective sorting symbol for Waste electrical and electronic equipment (WEEE). This means that this product must be handled pursuant to European directive 2012/19/EU in order to be recycled or dismantled to minimize its impact on the environment.</p> <p>User has the choice to give his product to a competent recycling organization or to the retailer when he buys a new electrical or electronic equipment.</p> |
|  | <p>Caution, avoid listening at high volume levels for long periods</p> |
|  | <p>Disconnection, all power plugs</p> |
| <p>m</p> | <p>Switch of mini-gap construction</p> |
| <p>μ</p> | <p>Switch of micro-gap construction (for US version) Switch of micro-gap / micro-disconnection construction (for other versions except US)</p> |
| <p>ε</p> | <p>Switch without contact gap (Semiconductor switching device)</p> |