

Technical Specification

Trademark	Sharp
Model ID	LC-32HI5232KF LC-32HI5232KFW LC-32DI5232KFW LC-32HI5332KF LC-32HI5432KF LC-32HI5532KF
Energy efficiency class	A+
Visible screen size (diagonal)	81 cm / 32 inches
On-mode power consumption	31.0 W
Annual energy consumption *1	45 kWh
Standby power consumption *2	<0.50 W
Off mode power consumption	n/a
Screen resolution	1366 (H) x 768 (V)

*1: Energy consumption XYZ kWh per year, based on the power consumption of the television operating 4 hours per day for 365 days. The actual energy consumption will depend on how the television is used.
*2: When the TV is turned off with the remote control/standby button and no function is active.

	LC-32HI5232KF LC-32HI5232KFW LC-32HI5332KF LC-32HI5432KF LC-32HI5532KF	LC-32DI5232KFW
RF	75 ohm Antenna / Analog / DVB / Satellite	
Inputs	3 x HDMI, 2 x USB, 1 x Mini-SCART, 1 x RJ45 LAN/Ethernet, 1 x Mini Component/YPbPr, 1 x Mini AV IN - Composite Video/CVBS and L/R Audio shared for Composite Video and Component/YPbPr	
Sound Outputs	1 x Digital Optical Audio output, 1 x 3.5mm Headphone	
Speaker* / Amplifier Watts (RMS)	2 x 10 / 2 x 8	
Voltage and power consumption	AC 220V ~ 240V; 50Hz 31/45/70W (home mode/standard/max) (<0.5W in Standby)	AC 220V ~ 240V; 50Hz 31/45/80W (home mode/standard/max) (<0.5W in Standby)
Dimensions including stand (mm)	732W x 470H x 173D	
Net weight (Kgs)	5.3	5.5
Wall Mounting	VESA 200 x 200 (mm)	

*Built-in Harman Kardon speaker systems (Full-range speaker and tweeter).

SOUND SYSTEM BY
harman / kardon

Harman Kardon is trademark of HARMAN International Industries, Incorporated, registered in the United States and/or other countries.

SHARP

Quick Start Set Up Guide

For information on using the TV's features, please refer to the operating Instructions.

Model Numbers

LC-32HI5232KF

LC-32HI5232KFW

LC-32DI5232KFW

LC-32HI5332KF

LC-32HI5432KF

LC-32HI5532KF

Register your manufacturers guarantee online within 14 days of purchase at

www.registertoday.co.uk/sharp and enter into a prize draw to



Quick & easy guide for setting up your TV

What is included in the box

Using the remote control

Setting up the TV for the first time - including attaching the stand

Connecting other devices to the Television

Need help setting up or using your TV?

Please contact the UK & ROI Helpline*

Telephone UK 0330 024 0803 or ROI 01443 3323

Online support at: www.umc-uk.co.uk

Email support at: service@umc-uk.co.uk

*Calls to 0330 numbers are charged at standard call rates and are included as part of any bundled minutes with your phone provider.

Calls to the ROI number are charged at the local call rate.

The telephone opening hours are Monday to Friday 8.30am to 6pm, Saturday 9am – 5pm.

Bank Holidays - 10am to 4pm

Closed Christmas and New Years day



Please save your box/packaging as you will need this in the event of warranty/service repair or support. We are unable to carry out warranty/service if you are unable to package it correctly. The safest way to package your item in the event of warranty/service repair is in its original box/packaging.

What is included in the box

Accessories included with this TV are the following accessories

- 1 x Operating Instructions
- 1 x Quick start guide
- 1 x TV
- 1 x Remote Control and 2 x AAA Batteries
- 1 x RF cable
- 1 x Power Cable
- 1 x Mini component / YPbPr cable
- 1 x SCART to Mini-SCART adapter
- 1 x Stand installation pack
- 4 x Screws
- 1 x L (left)
- 1 x R (right)

Sky Remote Code

If you wish to use your Sky remote to operate the TV's basic functions, you will need a Sky remote control (Revision 9 or later) and you will need to program it with the code 2134. If you wish to use your Sky Q remote to operate the TV's basic functions, you will need to program it with the code 4170.



Key

- For models with integrated DVD players.
- For models with PVR Function.
- For models with USB Playback.
- For models with 3D functions.

- STANDBY** - Switch on the TV when in standby or vice versa.
- FREEVIEW PLAY** - Access the Freeview Play app.
- NUMBER BUTTONS** - 0-9 to select a TV channel directly.
- MUTE** - Mute the sound or vice versa.
- TV GUIDE** - Opens the 7 day TV guide (digital TV mode).
- VOL (+/-)** - To increase/decrease the sound level.
- PICTURE** - Scrolls through picture mode options.
- SOUND** - Scrolls through sound mode options.
- SOURCE** - To display the input/source menu.
- CH (+/-)** - To increase or decrease the channel being watched.
- MENU** - To display OSD menu.
- EXIT** - To exit all menus.
- (A/V/OK)** - Allows you to navigate the on-screen menus and adjust the system settings to your preference.
- BACK** - To go back a previous step.
- FAV** - To display favourites menu.
- INFO** - Press once for now/next channel information.
- TEXT** - To enter/exit Text.
- SUBTITLE** - To switch the dialogue at the bottom of the screen (on/off).
- TV** - To switch to Digital Channels.
- YOUTUBE** - Access the Youtube App.
- NETFLIX** - Access the Netflix App.
- APPS** - Access the APPS menu.
- RECORD** - Access the USB record function.
- REC LIST** - Opens the list of previously recorded items.
- REPEAT** - To restart the current chapter.
- REPEAT** - To repeat playback.
- ANGLE/3D** - Select different angle of DVD.
- REPEAT** - To repeat playback.

Using the remote control

Setting up the TV set for the first time

1 Fitting the stand

For the stand installation, there is one type of screw provided as shown below.

To complete the stand installation you will require a cross head screw driver.

Place the TV set on a flat and clean surface with the panel facing downwards to avoid damage.



TV panel must be facing downwards.

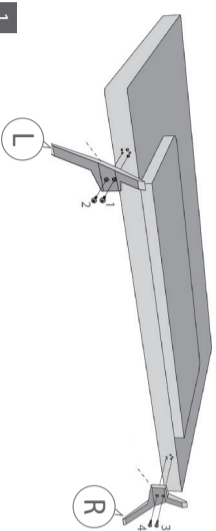

Place the TV set on a flat and clean surface with the panel facing downwards to avoid damage, then fix the stand feet shown. The feet are marked L (left) and R (right).

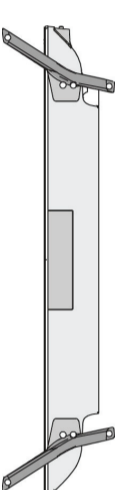

When the stand feet are installed correctly the stand feet will be longest at the front of the TV and shortest at the back with the feet pointing away from each other.

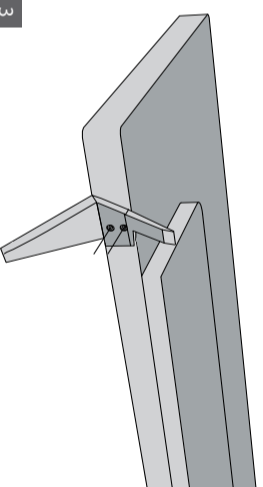

Secure the stand feet to the underside of the TV set using the 4 screws provided.

2 Connecting your set

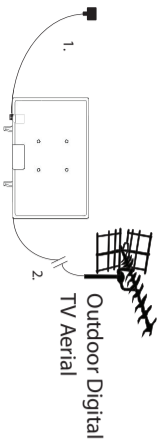

- 1) Connect the TV to your power socket.
- 2) If you wish to use the TV to receive Freeview/Saorview channels, connect the RF input from the TV to your outdoor Digital TV aerial. If you do not wish to receive Freeview/Saorview, skip this step.

3 Powering On the TV

TV Control Stick

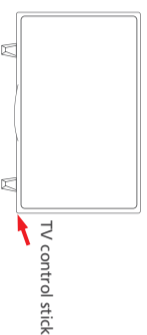

Switch on the television by pressing the TV control stick located on the TV set.

Remote Control: Installing Batteries

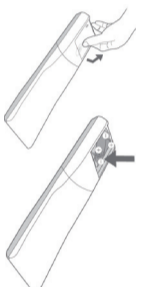

Insert the batteries supplied into the remote control and press the standby button to power on the TV.



To receive Freeview channels, in particular Freeview HD channels, you will need a Digital TV aerial and be in a good Freeview coverage area. You can check coverage for your postcode at www.freeview.co.uk.

Please note that any Freeview HD channels found during tuning will be placed in channel positions above 100. For example, 101 (BBC1 HD), 102 (BBC2 HD) etc.

4 First time installation



1. Languages

Select your preferred on screen display language. This will change the language in which the menus and associated information is displayed in. When set up has been completed, this can be changed by selecting Menu > Settings > Language



4. Environment of Use

Home Mode: For normal use, by default it is set to a power saving mode which reduces the energy used by up to 25%, (by reducing the power to the LED/LCD panel). This can be changed in the picture mode settings.

NOTE: In Home Mode, the TV will switch itself to the standby mode after 4 hours in the event that the buttons on the remote control or TV set are not used.

Store Mode: For store display use. The picture is adjusted to optimum settings. The store demonstration will appear on the screen automatically after two minutes.



2. Country Selection

Select the correct flag for the country in which the set will be used in. This will enable the set to correctly install the functions applicable in the country of use.

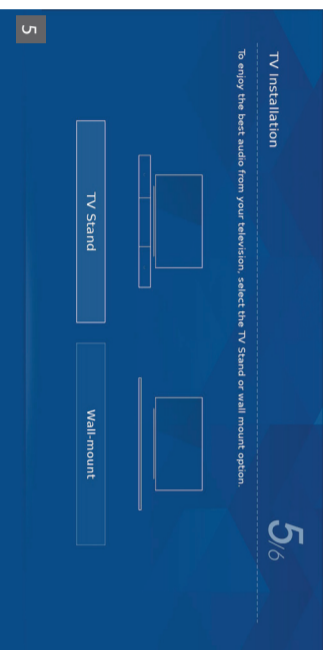

5. TV Installation – Audio.

Depending on how you use / install your TV, select the appropriate setting. The sound settings on the TV will adjust to suit the type of installation.

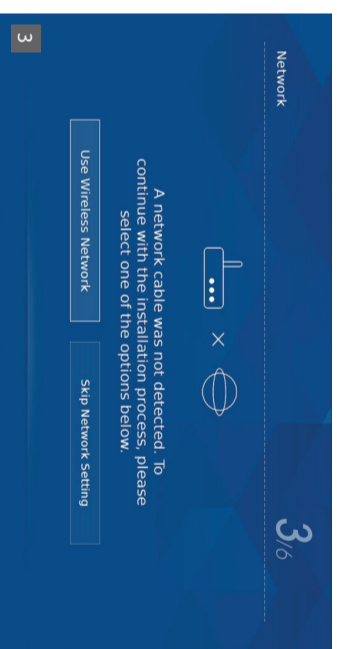

3. Network setup

You can connect the TV to your broadband router or wireless network in order to take advantage of the Smart functions. If you connect the TV to your router using an Ethernet cable (recommended) this step will be skipped. Follow the on screen prompts to connect to your wireless network. You can set up the Network connection later in the network menu.



6. Default Source

Select the source which you use the most. If Digital TV (Freeview) is chosen, then at the next step, the set will tune in and default to Digital TV (Freeview). If one of the other sources is selected, then the set will not tune in at this stage and default to that input. If it is required to tune the set in later, this can be achieved by selecting Menu > Channels

Win a **SHARP** Soundbar

Register your manufacturers guarantee online within 14 days of purchase at registertoday.co.uk/sharp and enter into a prize draw to win a Sharp Soundbar

Terms and conditions apply. Online registration only.



Connectivity

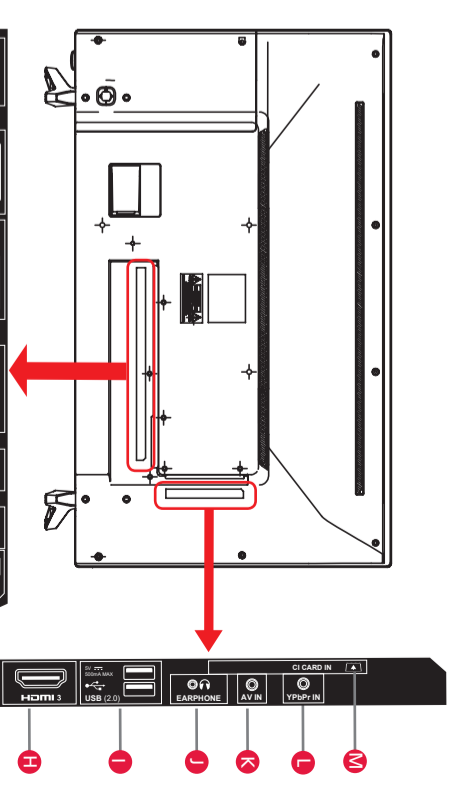

A Ethernet/LAN*	Network Connection	H HDMI 3	HDMI Input
B HDMI 1	HDMI Input	I 2 x USB	USB port
C HDMI 2 (ARC)	HDMI Input	J Earphone	Earphone output
D mini SCART	SCART Input	K AV IN	Audio/Video Input
E SAT IN	Satellite Input	L YPbPr	HD Input (YPbPr)
F RF IN	RF/TV Input	M CI/CARD IN	Common Interface module
G Optical Digital Audio	Digital Audio output		

* The Ethernet/LAN port is used for Freeview HD services and smart functions.