

# Fire Legend

## AOPEN FHD LED Projector QF15a/L80/CD80/U1P2201 Series

### User's Guide





## WARNING

To prevent electric shock, please do not open the device case. Internal components of the device are not user-serviceable. Please contact professional maintenance staff for repairs.

## NOTICE

- ✓ This is the air inlet of the projector. Avoid obstructing the air inlet with any objects during the use of the projector.
- ✓ Clean the dust filter of vents every **3-months** to avoid triggering the projector's LCD panel and COB protection mechanism due to poor ventilation.

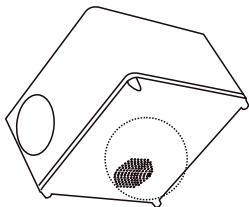

## PACKING LIST

1. Projector
2. Power Cord
3. Remote Control
4. HDMI Cable
5. Quick Start Guide
6. AV Cable

## Specification

Resolution	1920*1080P
Throw Ratio	TR1.4
Keystone	H/V and 4 Corner
Smart	Y, 1G/32G
Speaker	5W x 2
System power	138W
I/O	USB x2/HDMI/AV/Audio out
Image Size	42 ~ 100 inch
Dimensions	215 x 218 x 130 mm
Weight	2.1 Kg
Working Temperature	5 ~ 35°C

## ■ PARTS AND FUNCTIONS

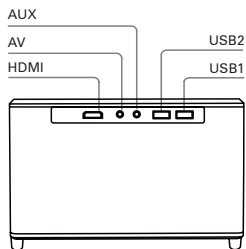
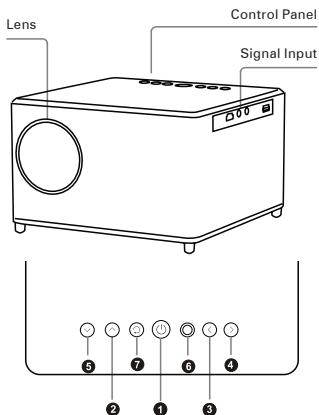

- 1 Power
- 2 ▲
- 3 ◀
- 4 ▶
- 5 ▼
- 6 OK
- 7 Back

### • Remote Control

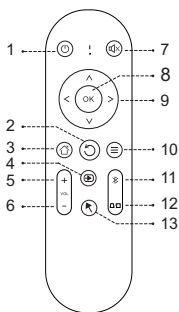

#	Icon	Function	Description
1		Power	Turn the projector on/off.
2		Back	Return to the previous page.
3		Home	Back to Home page.
4		Input	Change the input source.
5		VOLUME +	Increase the volume.
6		VOLUME -	Decrease the volume.
7		Mute	Mute the volume.
8		Select/Enter	Press to confirm the selection item.
9		Four directional selection keys	Use the up/down/left/right button to select items or make adjustments.
10		Menu	Display the OSD menu for various settings and adjustments.
11		Bluetooth	Search & connect Bluetooth device.
12		Keystone	Correct the shape of an image that is unevenly rectangular.
13		Mouse	Switch to Mouse mode for navigation key.
14		Infrared Transmitter	Send signals to the projector.

✓ The remote control is powered by two AAA batteries. (not included)

## ■ PROJECTOR CONNECTIONS

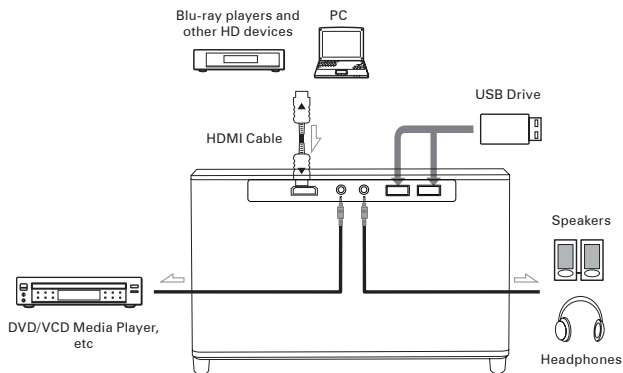

### • Projection Distance/Image Size

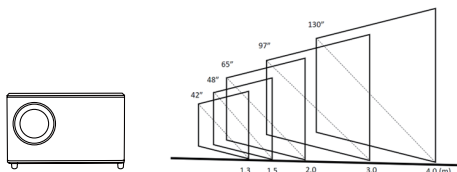

**REMARKS:** The displayed image size is for reference only. It is recommended to physically test the projection size and distance based on your specific needs.

### • Multimedia formats supported

Files	Format	Suffix	Decoding
Audio	MP3	.mp3	
	M4A	.mp4	
Picture	JPEG	.jpg	
	BMP	.bmp	
	PNG	.png	
Video	MPEG4	.AVI/.MP4	XVID
	H264	.MKV/.MOV	H.264
	MJPEG	.AVI	
	DivX	.AVI	MPEG, H.264



**REMARKS:** Dolby Digital (Dolby AC3) is not supported.

## ■ GETTING START

### • Power on/ Power off

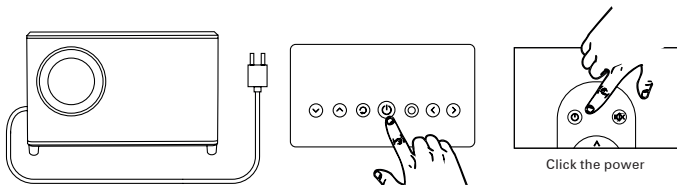

### • Projector installation

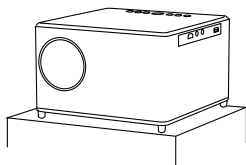

Desktop

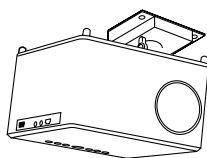

Ceiling

### • Image focus adjustment

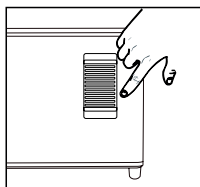

Rotate the lens to adjust the focus until the projected image is clear.



Blurred Image

## • Connect to the wireless network

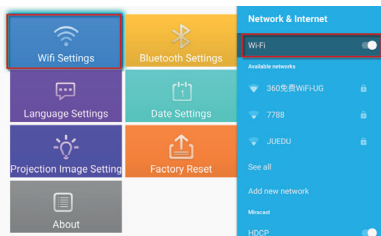

1. Turn on Wi-Fi by clicking “Wifi Settings” and press “OK”.
2. Select the desired network and press “OK” to confirm.

## • Bluetooth settings

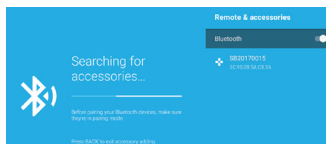
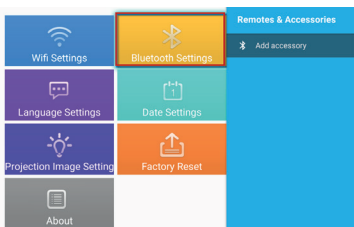

1. Click “Bluetooth Settings” and press “OK”. Then, click “Add accessory”.
2. Turn on the Bluetooth switch, search for the desired device (e.g. Bluetooth speakers), and connect.

## • Four-point keystone correction

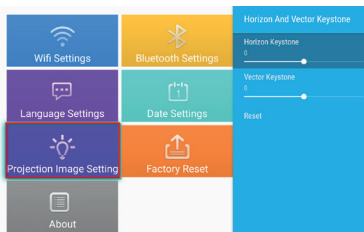

Select the best proportion for the roundness of the center circle.



- ⊙ Select
- ⊙ Adjust
- ⊙ Back
- ⊙ Reset

1. Select “Projection Image Settings” and adjust “Horizon and Vector Keystone” by pressing “OK” to confirm.
2. Adjust each corners separately until the image fits your desired shape.

- **Language selection:**

Select the language that best suits your personal preference.

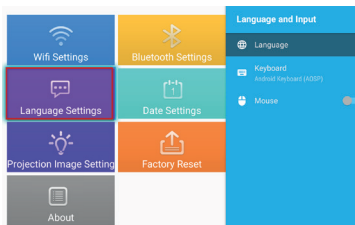

- **Date and Time setting:**

Select the preferred date and time format based on your personal preference.

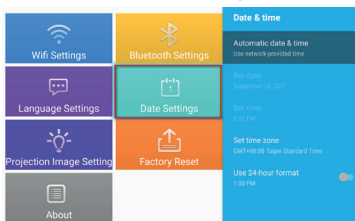

- **Application settings:**

Click on "Application Settings" to view all downloaded apps and select the app you want to use.

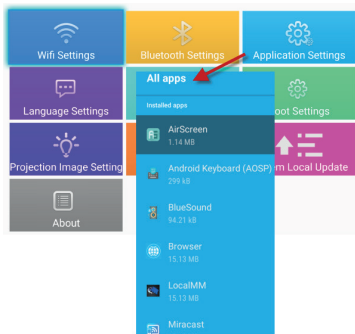

## ■ OPERATING INSTRUCTIONS

To use Bluetooth speaker mode, please follow these steps:

1. Go to the “My apps” menu and select “BlueSound”.
2. Connect your Bluetooth speakers to the projector.
3. Ensure your mobile phone, PC or NB is paired and connected to the Bluetooth speakers before use.

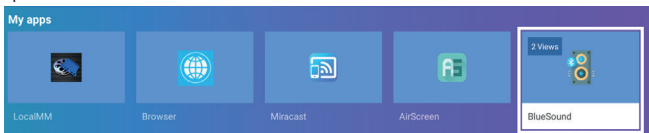

## ■ PLAYBACK INSTRUCTIONS

To use Multimedia local playback, please follow these steps:

1. Go to the “My apps” menu and select “LocalMM” app.
2. Access the internal storage or insert a USB flash device formatted in FAT32.
3. Select the media file you want to playback.

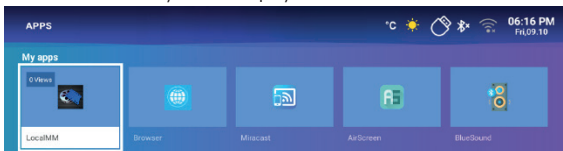



## ■ SCREEN MIRRORING INSTRUCTIONS

### • Windows system:

1. Go to the “My apps” menu and select “Miracast” app.
2. Press the Windows logo Key (Win+P) and (Win+K), then select the wireless display “QF15a” to start projection.

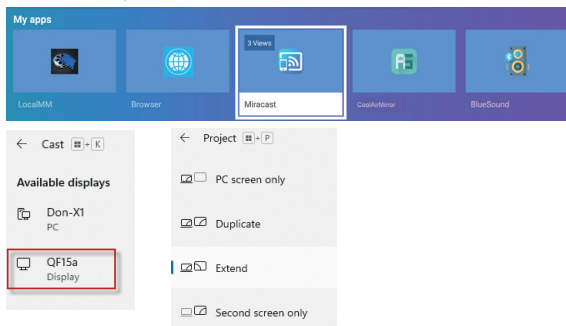

### • Android system:

Miracast:

1. Turn on the wireless display function on your mobile device.
2. Select the “QF15a” from the list of available devices to start projection.

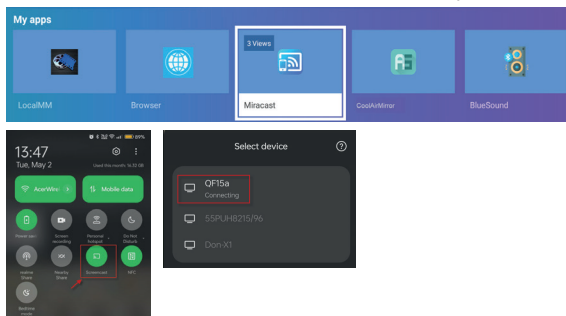

## DLNA:

1. To use DLNA streaming, download a DLNA app and connect to the same Wi-Fi as the projector.
2. In the DLNA APP, select "QF15a" as DLNA DMR/DMP and choose a file to play on the projector.

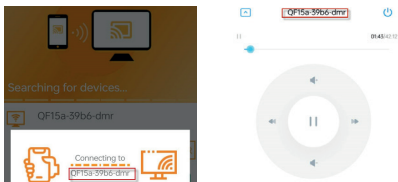

## • iOS system:

1. Ensure both your projector and mobile device are connected to the same Wi-Fi router.
2. Access the Screen Mirroring feature on your mobile device and select the "QF15a-xxxxxx" from the list to start projection.

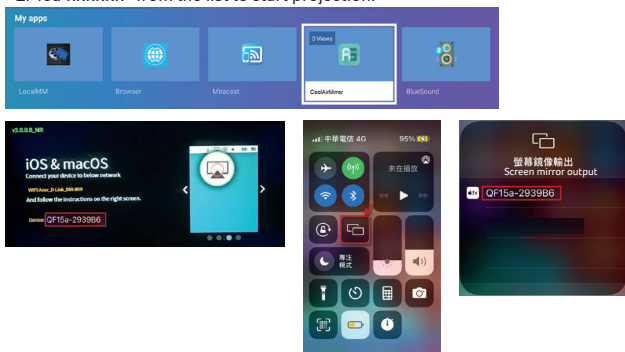

## ■ INPUT SOURCE SELECTION

In the home page, press the "up" button twice for the source menu.

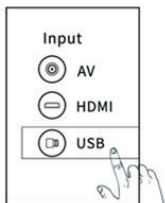

## ■ DOWNLOAD APPS FROM THE APP MARKET

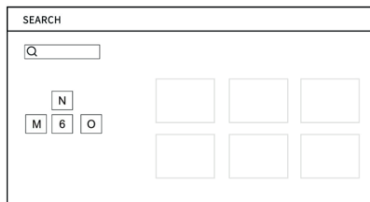

## ■ Common issues and solutions

### Troubleshooting

Issues	Solutions
No power, LED off, and the projector cannot power on.	Check the power cable for loose connection.
LED on but the projector cannot power on	Check the power cable for loose connection, press the Power button to turn on the projector.
Cannot screen mirror	<ol style="list-style-type: none"><li>1. Refer to the user guide for the correct screen mirroring function.</li><li>2. Shorten the distance between the smart device and projector for better screen mirroring quality.</li><li>3. Ensure that the smart phone is connected to the correct Wi-Fi network SSID.</li></ol>
Cannot stream media	Check the internet connection for your smart device.
Remote not responsive	<ol style="list-style-type: none"><li>1. Replace remote batteries.</li><li>2. Make sure the remote control is aligned with the IR sensor.</li></ol>
Unable to power off the projector	Press and hold the Power button for 5 seconds until the projector turns off.

## ■ DISPOSAL INSTRUCTIONS



This symbol on the product or on its packaging indicates that the product must not be disposed of with other household waste. When disposing of used devices, it is your responsibility to bring it to a collection point that recycles used electrical and electronic equipment. The separate collection and recycling of used devices at the time of disposal helps to conserve natural resources and ensures that they are recycled in a manner that protects human health and the environment. For more information about recycling points for used devices, please contact your local city office, household waste disposal service, or the shop where you purchased the product.

## ■ CLEANING METHODS

Before cleaning, ensure that the power socket is unplugged. Do not use pesticides or other volatile chemicals on the projector or lens, and avoid leaving rubber or vinyl products in contact with the projector for extended periods of time, as this may damage or peel off the remaining layers.

### Cleaning the projector:

1. Use a soft and dry cotton cloth to wipe the surface of the projector.
2. Dampen a soft cotton cloth with a diluted neutral cleaner, and gently wipe the projector surface. Dry with a dry cotton cloth.
3. Do not use water, benzene, or other solvents on the projector.
4. Do not scratch the main body of the projector with fingernails or other hard objects.

### Cleaning the lens:

1. Blow off the dust on the lens surface, and wipe off any stains with a soft cloth.
2. Use a professional dryer or lens cleaning paper specifically for camera and glasses.

**REMARKS:** Do not use ordinary tissue to clean the lens. Ordinary tissue contains large particles of impurities that may scratch the lens.

### Cleaning the outlet dust filter:

Turn off the power and unplug the power cord before cleaning the outlet dust filter of vents every three months. This will prevent poor ventilation from triggering the projector LCD panel and COB protection mechanism.