



OWNER'S MANUAL

# Sound Bar

Please read this manual carefully before operating your set and retain it for future reference.

MODEL  
SK1

[www.lg.com](http://www.lg.com)

Copyright © 2018 LG Electronics Inc. All Rights Reserved.

# Safety Information



**CAUTION**  
RISK OF ELECTRIC SHOCK  
DO NOT OPEN



**CAUTION:** TO REDUCE THE RISK OF ELECTRIC SHOCK DO NOT REMOVE COVER (OR BACK) NO USER-SERVICEABLE PARTS INSIDE REFER SERVICING TO QUALIFIED SERVICE PERSONNEL



This lightning flash with arrowhead symbol within an equilateral triangle is intended to alert the user to the presence of uninsulated dangerous voltage within the product's enclosure that may be of sufficient magnitude to constitute a risk of electric shock to persons.



The exclamation point within an equilateral triangle is intended to alert the user to the presence of important operating and maintenance (servicing) instructions in the literature accompanying the product.

**WARNING:** TO PREVENT FIRE OR ELECTRIC SHOCK HAZARD, DO NOT EXPOSE THIS PRODUCT TO RAIN OR MOISTURE.

**CAUTION:** The apparatus should not be exposed to water (dripping or splashing) and no objects filled with liquids, such as vases, should be placed on the apparatus.

**WARNING:** Do not install this equipment in a confined space such as a book case or similar unit.

**CAUTION:** Do not use high voltage products around this product. (ex. Electrical swatter) This product may malfunction due to electrical shock.

**CAUTION:** No naked flame sources, such as lighted candles, should be placed on the apparatus.

**CAUTION:** Do not block any ventilation openings. Install in accordance with the manufacturer's instructions.

Slots and openings in the cabinet are provided for ventilation and to ensure reliable operation of the product and to protect it from over heating. The openings shall never be blocked by placing the product on a bed, sofa, rug or other similar surface. This product shall not be placed in a built-in installation such as a bookcase or rack unless proper ventilation is provided or the manufacturer's instruction has been adhered to.

**CAUTION concerning the Power Cord**

The Power Plug is the disconnecting device. In case of an emergency, the Power Plug must remain readily accessible.

Check the specification page of this owner's manual to be certain of the current requirements.

Do not overload wall outlets. Overloaded wall outlets, loose or damaged wall outlets, extension cords, frayed power cords, or damaged or cracked wire insulation are dangerous. Any of these conditions could result in electric shock or fire. Periodically examine the cord of your device, and if its appearance indicates damage or deterioration, unplug it, discontinue use of the device, and have the cord replaced with an exact replacement part by an authorized service center. Protect the power cord from physical or mechanical abuse, such as being twisted, kinked, pinched, closed in a door, or walked upon. Pay particular attention to plugs, wall outlets, and the point where the cord exits the device.

**NOTICE:** For safety marking information including product identification and power supply ratings, please refer to the main label on the bottom or the other surface of the product.

This device is equipped with a portable battery or accumulator.

**How to Safely remove the batteries or the battery pack from the equipment:** To Remove the old batteries or battery pack, follow the assembly steps in reverse order. To prevent contamination of the environment and bring on possible threat to human and/or animal health, the old batteries or the battery pack must be put in an appropriate container at designated collection points. Do not dispose of batteries or battery pack together with other waste. It is recommended that you use local, free reimbursement systems batteries or battery packs, (may not be available in your area). The batteries or the battery pack should not be exposed to excessive heat such as sunshine, fire or the like.

## Symbols

~	Refers to alternating current (AC).
≡	Refers to direct current (DC).
⊞	Refers to class II equipment.
⏻	Refers to stand-by.
⏻	Refers to "ON" (power).
⚡	Refers to dangerous voltage.

# Table of Contents

## 1 Getting Started

---

- 2 Safety Information
- 6 Unique features
- 6 Introduction
  - 6 – Symbols used in this manual
- 7 Remote control
- 8 Front panel
- 8 Rear panel
- 9 About LED condition
- 11 Installing the sound bar
- 12 Mounting the main unit on a wall (Optional)

## 2 Connecting

---

- 14 Organizing cables (Optional)
- 14 Connecting to your TV
  - 14 – Using an optical cable
  - 15 – LG Sound Sync (Optical)
- 16 Optional equipment connection
  - 16 – OPT.IN connection
  - 16 – PORT.IN connection

## 3 Operating

---

- 17 Operations
  - 17 – DRC (Dynamic Range Control)
  - 17 – Turn off the sound temporarily
  - 17 – Using your TV remote control
  - 17 – Auto power down
  - 18 – AUTO POWER On/Off
  - 19 – Auto function change
- 20 Using BLUETOOTH® technology
  - 20 – Listening to music stored on the Bluetooth devices
- 22 Sound adjustment

## 4 Troubleshooting

---

- 23 Troubleshooting
  - 23 – General
  - 24 – NOTES to use wireless

## 5 Appendix

---

- 25 Trademarks and licenses
- 26 Specifications
- 27 Maintenance
  - 27 – Handling the unit

1

2

3

4

5

## Unique features

### Auto power down

This unit supports to turn off by itself for saving energy consumption.

### Portable In

Listen to music from your portable device. (MP3 player, Notebook, Smart phone, etc..)

### BLUETOOTH®

Listens to music stored on your **Bluetooth** device.

## Introduction

### Symbols used in this manual

 **Note**

Indicates special notes and operating features.

 **Caution**

Indicates cautions for preventing possible damages from abuse.

## Remote control

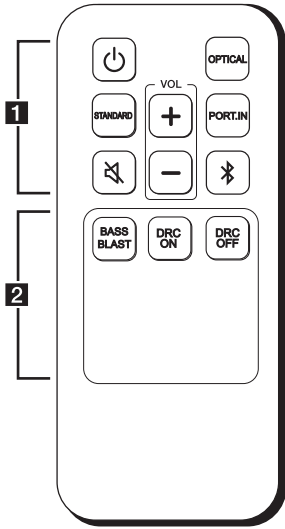

### Replacement of battery

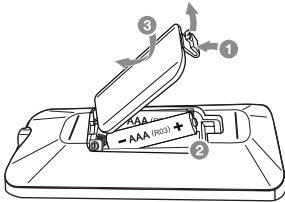

Remove the battery cover on the rear of the remote control, and insert battery with **+** and **-** matched correctly.

..... **1** .....

**⏻ (Standby)**: Switches the unit ON or OFF.

#### OPTICAL :

- Selects the optical function.
- Turns on the **Bluetooth** connection lock function. (Page 21)

#### STANDARD :

- Selects standardized sound.
- Turns on AUTO POWER function. (Page 18)

#### PORT.IN (Portable in) :

- Selects the portable function and source.
- Turns off the **Bluetooth** connection lock function. (Page 21)

#### **🔇 (Mute)** :

- Mutes the sound.
- Turns off AUTO POWER function. (Page 18)

**📶 (Bluetooth)** : Selects the **Bluetooth** function and source.

**VOL +/—** : Adjusts speaker volume.

..... **2** .....

**BASS BLAST** : Reinforces the bass and powerful sound.

#### DRC ON/OFF :

- Turns on or off DRC function. (Page 17)
- Controls this unit using TV remote. (Page 17)

## Front panel

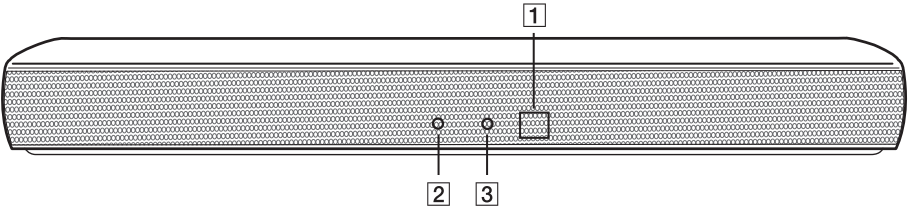

- 1 Remote sensor
- 2 State LED
- 3 Bluetooth LED

**!** Note

This unit operates only with the remote control.

## Rear panel

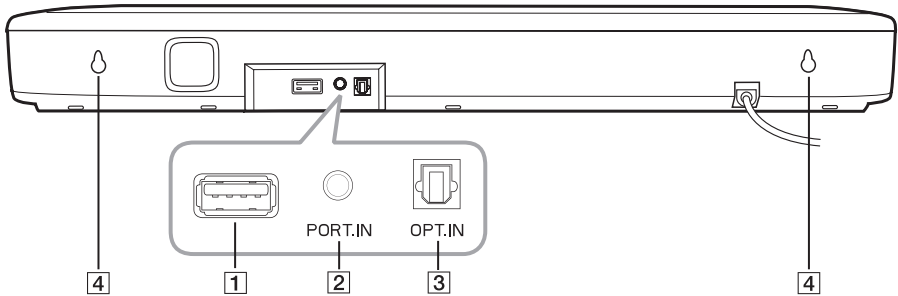

- 1 USB (Service only) : S/W download connector.
- 2 **PORT.IN** (Portable) : Connect to a portable device.
- 3 **OPT. IN** (Optical) : Connect to an optical device.

- 4 Wall mount hole : You can mount the sound bar on a wall. (Page 12-13)

**!** Caution

Be careful to make sure children do not put their hands or any objects into the \*speaker duct.  
 \* speaker duct : A hole for plentiful bass sound on speaker cabinet (enclosure)



## About LED condition

- : White LED is staying on.      ☀ : White LED is blinking.      ○ : LED is off.
- : Color LED is staying on.      ● : Color LED is blinking.

LED	Condition	Description
(White) ○      ○	State LED (White) turns on.	Optical function is selected.
(White) ☀      ○ ▼ (White) ○      ○	State LED (White) blinks twice and turns on.	LG Sound Sync (Optical) function is selected.
○      (Blue) ☀	<b>Bluetooth</b> LED (Blue) blinks.	Slow blink : Waiting for <b>Bluetooth</b> connection. Quick blink : Connecting <b>Bluetooth</b> .
○      (Blue) ●	<b>Bluetooth</b> LED (Blue) turns on.	Paired with <b>Bluetooth</b> device.
(Green) ●      ○	State LED (Green) turns on.	Portable function is selected.

### ! Note

- When you press any button, State LED (Red) on the main unit blinks.
- When you press  (Mute) button, State LED (White) and **Bluetooth** LED (White) blink slowly.
- When this unit reaches minimum volume, State LED (White) and **Bluetooth** LED (White) turn on for 2 seconds and blink slowly.
- When this unit reaches maximum volume, State LED (White) and **Bluetooth** LED (White) turn on for 2 seconds.
- When you press volume (+/-) button continually, State LED (Red) blinks quickly.

## Useful functions for using the unit

Function	Description	To do	Do this
TV Remote On/Off (Page 17)	It allows you to control the volume of this unit by your TV remote control even by other company's product.  Initial setting of this function was set to on.	ON	Press and hold <b>DRC ON</b> on the remote control for about 2 seconds.  The State LED (White) and <b>Bluetooth</b> LED (White) blink twice.
		OFF	Press and hold <b>DRC OFF</b> on the remote control for about 2 seconds.  The State LED (White) and <b>Bluetooth</b> LED (White) blink twice.
BT Lock On/Off (Page 21)	It allows you to connect a <b>Bluetooth</b> device only on <b>Bluetooth</b> function.  Initial setting of this function was set to off.	ON	Press and hold <b>OPTICAL</b> on the remote control for about 2 seconds in <b>Bluetooth</b> function.  The State LED (White) and <b>Bluetooth</b> LED (White) blink twice.
		OFF	Press and hold <b>PORT.IN</b> on the remote control for about 2 seconds in <b>Bluetooth</b> function.  The State LED (White) and <b>Bluetooth</b> LED (White) blink twice.
Auto Power On/Off (Page 18)	It allows the unit to turn on and off automatically by input signals : Optical, <b>Bluetooth</b> .  Initial setting of this function was set to on.	ON	Press and hold <b>STANDARD</b> on the remote control for about 2 seconds.  The State LED (White) and <b>Bluetooth</b> LED (White) blink twice.
		OFF	Press and hold  (Mute) on the remote control for about 2 seconds.  The State LED (White) and <b>Bluetooth</b> LED (White) blink twice.

## Installing the sound bar

You can hear the sound by connecting the unit to the other device : TV, Blu-ray disc player, DVD player, etc.

Place the unit in front of the TV and connect it to the device you want. (Page 14 - 16)



### ⚠ Caution

- For best performance of wireless connection such as **Bluetooth**, do not install the unit on Metallic furniture because wireless connection communicates through a module positioned on the bottom of the unit.
- Be careful not to make scratches on the surface of the unit when installing or moving it.

# Mounting the main unit on a wall (Optional)

You can mount the main unit on a wall.



### ! Caution

Because it is difficult to make a connection after installing this unit, you should connect the cables before installation.

## Preparation materials



Unit

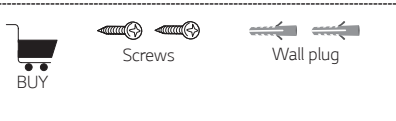

Screws

Wall plug

1. Place the unit with the bottom of TV and attach to the location. Align to center the unit on the TV.

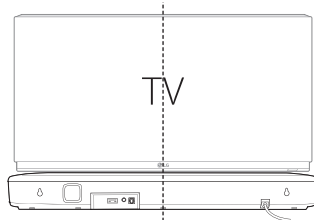

2. When you mount it on a wall (concrete), use the wall plugs. You should drill holes. Use the holes on the bottom of the unit to check the point to drill.

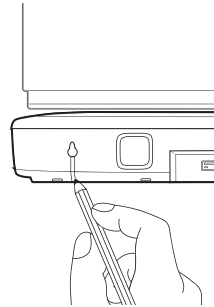

### ! Note

When you mark the hole position with drill, adjust horizontal.

3. Fix the screws and wall plugs as shown in the illustration below.

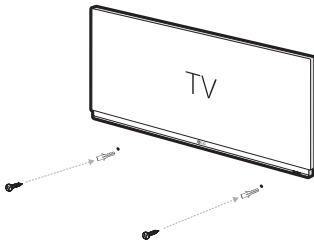

**! Note**

- Screws and Wall Plugs are not supplied for mounting the unit. Recommend the size of screws is as follows. : Diameter 4 mm, length 40 mm or so.
- Screws tighten leaving the screws 10 mm.

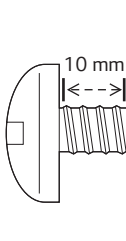

4. Hang the main unit on wall as shown below.

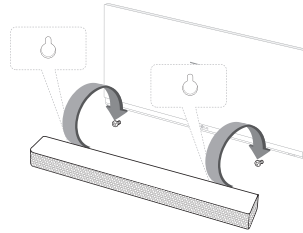

**! Note**

To detach the unit, perform it in reverse order.

**! Caution**

- Do not install this unit upside down. It can damage the parts of this unit or be the cause of personal injury.
- Do not hang onto the installed unit and avoid any impact to the unit.
- Secure the unit firmly to the wall so that it does not fall off. If the unit falls off, it may result in an injury or damage to the product.
- When the unit is installed on a wall, please make sure that a child does not pull any of connecting cables, as it may cause it to fall.

## Organizing cables (Optional)

You can organize the cable with cable ties.

1. Hold the cables together with cable ties as shown below.
2. Tighten cable ties.

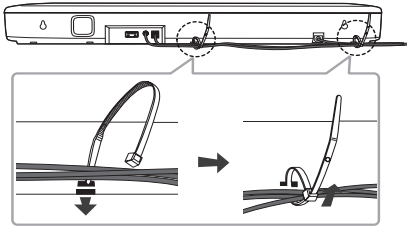

### ! Note

- After all connections are completed, you can arrange cables as needed.
- Cable ties are not supported.

## Connecting to your TV

### Using an optical cable

1. Connect the OPT. IN jack on the back of the unit to OPTICAL OUT jack on the TV using an optical cable.

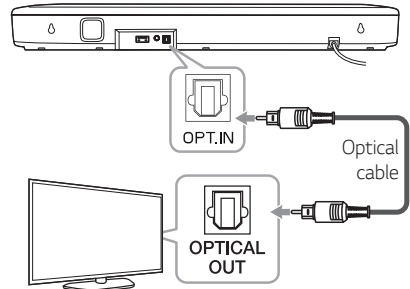

2. Select the input source to optical by pressing **OPTICAL** button on the remote control.

You can see State LED (White) is staying on. Then optical function is selected.

### ! Note

- Before connecting the optical cable, be sure to remove the protection plug cover if your cable has the cover.
- You can enjoy the TV audio through the speakers of this unit. In the case of some TV models, you must select the external speaker option from the TV menu. (For details, reference your TV user manual.)
- Set up the sound output of TV to listen to the sound through this unit :  
TV setting menu → [Sound] → [TV Sound output] → [External speaker (Optical)]
- Details of TV setting menu vary depending on the manufacturers or models of your TV.

## LG Sound Sync (Optical)

# Sound Sync

You can control some functions of this unit by your TV's remote control with LG Sound Sync. It is compatible with the LG TV that is supported LG Sound Sync. Make sure of the LG Sound Sync logo on your TV.

Controllable function by LG TV's remote control :  
Volume up/down, mute

Refer to the TV's instruction manual for the details of LG Sound Sync.

Make one of the following connections, depending on the capabilities of your equipment.

### ! Note

- You can also use the remote control of this unit while using LG Sound Sync. If you use TV's remote control again, the unit synchronizes with the TV.
- When the connection fails, make sure of the condition of the TV and power.
- Make sure of the condition of this unit and the connection in the cases below when using LG Sound Sync.
  - The unit is turned off.
  - Changing the function to the others.
  - Disconnecting the optical cable.
- The amount of time to turn off this unit is different depending on your TV when you set AUTO POWER function to ON.
- If the connected TV is set to LG Sound Sync, the unit automatically switches to LG Sound Sync.

1. Connect your LG TV to the unit by using an optical cable.

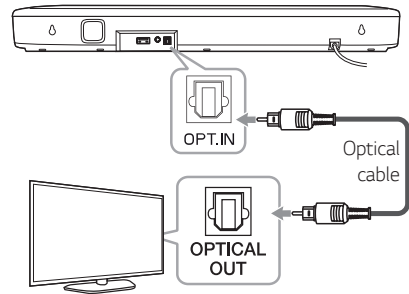

2. Set up the sound output of TV to listen to the sound through this unit :  
TV setting menu → [Sound] → [TV Sound output] → [LG Sound Sync (Optical)]
3. Turn on the unit by pressing on the remote control.
4. Select the input source to optical by pressing **OPTICAL** button on the remote control  
You can see State LED (White) blinks twice. Then State LED (White) is staying on if connecting normally between this unit and your TV.

### ! Note

Details of TV setting menu vary depending on the models of your TV.

## Optional equipment connection

### OPT. IN connection

Connect an optical output jack of external devices to the OPT. IN jack.

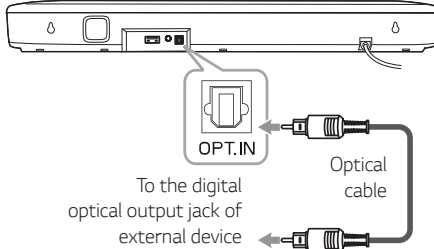

1. Connect the OPT. IN jack on the back of the unit to OPTICAL OUT jack of your external device.
2. Select the input source to optical by pressing **OPTICAL** button on the remote control. You can see State LED (White) is staying on. Then optical function is selected.
3. Listen to sound.

#### ! Note

Before connecting the optical cable, be sure to remove the protection plug cover if your cable has the cover.

### PORT. IN connection

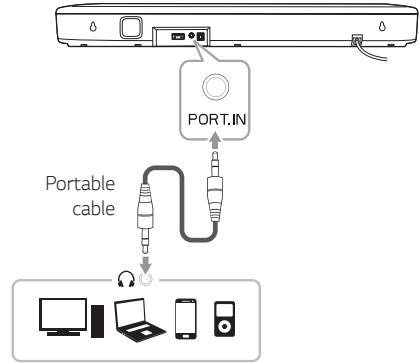

### Listening to music from your portable player

The unit can be used to play the music from many types of portable players or external devices.

1. Connect the portable player to the PORT. IN connector of the unit by using 3.5 mm stereo cable.
2. Select the input source to Portable by pressing **PORT.IN** button on the remote control. You can see State LED (Green) is staying on. Then portable function is selected.
3. Turn on the portable player or external device and start playing it.





## Operations

### DRC (Dynamic Range Control)

Make the sound clear when the volume is turned down and prevent sudden increase of sound (Dolby Digital only). This function turns on or off when you press **DRC ON/OFF**.

### Turn off the sound temporarily

Press  (Mute) to mute your unit.  
To cancel it, press  (Mute) again on the remote control or change the volume level.

### Using your TV remote control

You can control some functions of this unit by your TV remote control even by other company's product. Controllable functions are volume up/down and mute.

Press and hold **DRC ON** on the remote control for about 2 seconds. Then the State LED (White) and **Bluetooth** LED (White) blink twice. After that, this function is enabled.

To turn off this function, press and hold **DRC OFF** about 2 seconds. Then the State LED (White) and **Bluetooth** LED (White) blink twice. After that, this function is disabled.

#### Note

- Supported TV brands

LG	Panasonic	Philips	Samsung
Sharp	Sony	Toshiba	Vizio

- Make sure that the sound output of your TV is set to [External speaker].
- Depending on the remote control, this function may not work well.
- This function does not operate on LG TV's magic remote control.

### Auto power down

This unit will turn itself off to save electric consumption if the main unit is not connected to an external device and has not been used for 15 minutes.

This unit also turns off after six hours if the Main unit has been connected to another device using the analog input. (Ex : Portable, etc.)

## AUTO POWER On/Off

This sound bar automatically turns on and off by an input source : Optical, **Bluetooth**.

To turns on this function, press and hold **STANDARD** on the remote control for about 2 seconds.

To turns off this function, press and hold  (Mute) on the remote control for about 2 seconds.

### Turning on

When you turn on your TV or an external device connected to this unit, this unit recognizes the input signal and selects the suitable function. You can hear the sound from your device.

If you try to connect your **Bluetooth** device, this unit turns on and the unit will be connected to your **Bluetooth** device.

### Turning off

When the TV is off, this sound bar switches to the standby mode.

### Note

- After the unit is turned on by AUTO POWER function, it will be automatically turned off if there is no signal for a certain period of time from the external device.
- If you turned off the unit directly, it cannot be turned on automatically by AUTO POWER function. However the unit can be turned on by AUTO POWER function when optical signal comes in after 5 seconds of no signal.
- Depending on the connected device, this function may not operate.
- If you disconnect **Bluetooth** connection by this unit, some **Bluetooth** devices try to connect to the unit continually. Therefore it is recommended to disconnect the connection before turn off the unit.
- When you turn on this unit for the first time, Auto Power function is turned on status.
- To use this function, the main unit must be registered in paired devices list of **Bluetooth** device.
- You can set the AUTO POWER function only when this unit is turned on.

## Auto function change

This unit recognizes input signals such as optical, **Bluetooth** and Portable and then changes suitable function automatically.

### When optical signal comes in

When you turn on the external device connected to this unit by an optical cable, this unit change the function to optical. You can hear the sound from your device.

### When you try to connect Bluetooth device

When you try to connect your **Bluetooth** device to this unit, **Bluetooth** function is selected. Play your music on the **Bluetooth** device.

### When connect a Portable device

When you connect your portable device using 3.5 mm stereo cable, this unit changes the function to Portable. You can hear the music from your device.

#### Note

- To change to optical function, it needs 5 seconds of no signal.
- If the **Bluetooth** connection lock function is set, **Bluetooth** connection will be only available on **Bluetooth** function.  
(Page 21)

# Using BLUETOOTH® technology

## About Bluetooth

**Bluetooth** is wireless communication technology for short range connection.

The sound may be interrupted when the connection interfered by the other electronic wave or you connect the **Bluetooth** in the other rooms.

Connecting individual devices under **Bluetooth** wireless technology does not incur any charges.

A mobile phone with **Bluetooth** wireless technology can be operated via the Cascade if the connection was made via **Bluetooth** wireless technology.

- Available Devices : Smart phone, MP3 player, Notebook, etc..
- Version : 4.0
- Codec : SBC, AAC

## Bluetooth Profiles

In order to use **Bluetooth** wireless technology, devices must be able to interpret certain profiles. This unit is compatible with following profile.

A2DP (Advanced Audio Distribution Profile)

## Listening to music stored on the Bluetooth devices

### Pairing your unit and Bluetooth device

Before you start the pairing procedure, make sure the **Bluetooth** feature is turned on in to your **Bluetooth** device. Refer to your **Bluetooth** device's user guide. Once a pairing operation is performed, it does not need to be performed again.

1. Select the input source to **Bluetooth** by pressing **⌘ (Bluetooth)** button on the remote control. **Bluetooth** LED will blink.
2. Operate the **Bluetooth** device and perform the pairing operation. When searching for this unit with the **Bluetooth** device, a list of the devices found may appear in the **Bluetooth** device display depending on the type of **Bluetooth** device. Your unit appears as "LG-SK1 (XX)".

#### ! Note

- XX means the last two digits of **Bluetooth** address. For example, if your unit has a **Bluetooth** address such as 9C:02:98:4A:F7:08, you will see "LG-SK1 (08)" on your **Bluetooth** device.
- Depending on the **Bluetooth** device type, some device have a different pairing way. Enter the PIN code (0000) as needed.

3. When this unit is successfully connected with your **Bluetooth** device, **Bluetooth** LED (Blue) will be staying on.
4. Listen to music.  
To play a music stored on your **Bluetooth** device, refer to your **Bluetooth** device's user guide.

### ! Note

- When using **Bluetooth** technology, you have to make a connection between the unit and the **Bluetooth** device as close as possible and keep the distance. However it may not work well in the cases below :
  - There is an obstacle between the unit and the **Bluetooth** device.
  - There is a device using same frequency with **Bluetooth** technology such as a medical equipment, a microwave or a wireless LAN device.
- If **Bluetooth** connection does not work well, try pairing it again.
- The sound may be interrupted when the connection interfered by the other electronic wave.
- Pairing is limited one **Bluetooth** device per one unit and multi-pairing is not supported.
- Depending on the type of the device, you may not be able to use the **Bluetooth** function.
- You can enjoy **Bluetooth** function using Smart phone, MP3 player, Notebook, etc..
- The more distance between the unit and the **Bluetooth** device, the lower the sound quality becomes.
- **Bluetooth** connection will be disconnected when the unit is turned off or the **Bluetooth** device gets far from the unit.
- When **Bluetooth** connection is disconnected, connect the **Bluetooth** device to the unit again.
- When the unit is not connected with **Bluetooth** device, **Bluetooth** LED will blink.

### BLUETOOTH connection lock (BT lock)

You can limit **Bluetooth** connection to only **Bluetooth** function to prevent unintended **Bluetooth** connection.

Press and hold **OPTICAL** on the remote control for about 2 seconds to turn on this function in **Bluetooth** function. Then the State LED (White) and **Bluetooth** LED (White) blink twice. After that, this function is enabled.

To turn off this function, press and hold **PORT.IN** on the remote control for about 2 seconds in **Bluetooth** function. Then the State LED (White) and **Bluetooth** LED (White) blink twice. After that, this function is disabled.

### ! Note

Even if you set up **Bluetooth** connection lock to On, this sound bar turns on by Auto Power function. Turn off Auto Power function to prevent it. (Page 18)

## Sound adjustment

This system has two pre-set surround sound fields. You can select a desired sound mode by using each sound mode button.

Sound effect	Description
STANDARD	You can enjoy optimized sound.
BASS BLAST	Reinforces the bass and powerful sound.

### Note

- In some of sound effect mode, some speakers, there's no sound or low sound. It depends on the mode of sound and the source of audio, it is not defective.
- You may need to reset the sound effect mode, after switching the input, sometimes even after the sound file changed.

# Troubleshooting

## General

PROBLEM	CAUSE & CORRECTION
The unit does not work properly.	<ul style="list-style-type: none"> <li>• Turn off the power of this unit and the connected external device (TV, Woofer, DVD-player, Amplifier, etc.) and turn them on again.</li> <li>• Disconnect the power cord of this unit and the connected external device (TV, Woofer, DVD-player, Amplifier, etc.) and then try connecting again.</li> <li>• Previous setting may not be saved when device power is shut off.</li> </ul>
No Power	<ul style="list-style-type: none"> <li>• The power cord is unplugged. Plug in the power cord.</li> <li>• Check whether electricity failed. Check the condition by operating other electronic devices.</li> </ul>
No sound	<ul style="list-style-type: none"> <li>• Incorrect input source is selected. Check the input source and select the correct input source.</li> <li>• The mute function is activated. Press  (Mute) or adjust the volume level to cancel the mute function.</li> <li>• When you are using connection with an external device (set top box, <b>Bluetooth</b> device etc.), adjust volume level of the device.</li> </ul>
The remote control does not work properly.	<ul style="list-style-type: none"> <li>• The remote control is too far from the unit. Operate the remote control within about 7 m.</li> <li>• There is an obstacle in the path of the remote control and the unit. Remove the obstacle.</li> <li>• The batteries in the remote control is exhausted. Replace the batteries with new one.</li> </ul>
The AUTO POWER function does not work.	<ul style="list-style-type: none"> <li>• Check connection of the external device such as TV, DVD/Blu-Ray player or <b>Bluetooth</b> device.</li> <li>• Depending on the connected device, this function may not operate.</li> </ul>
The unit does not connect with <b>Bluetooth</b> device	<ul style="list-style-type: none"> <li>• Turn off the <b>Bluetooth</b> connection lock function. (Page 21)</li> </ul>

PROBLEM	CAUSE & CORRECTION
<p>When you feel the output sound of the unit is low.</p>	<p>Check the details below and adjust the unit according to them.</p> <ul style="list-style-type: none"> <li>• Switch [ON] state of DRC function to [OFF] by using remote controller.</li> <li>• With the sound bar connected with TV, change the AUDIO DIGITAL OUT setting on TV Setup Menu from [PCM] to [AUTO] or [BITSTREAM].</li> <li>• With the sound bar connected with Player, change the AUDIO DIGITAL OUT setting on Player Setup Menu from [PCM] to [PRIMARY PASS-THROUGH] or [BITSTREAM].</li> </ul>

## NOTES to use wireless

PROBLEM	CAUSE & CORRECTION
<p>This device may have wireless interference.</p>	<ul style="list-style-type: none"> <li>• Wireless may not operate normally in weak signal area.</li> <li>• Do not install the device on metal furniture for optimum performance.</li> </ul>
<p><b>Bluetooth</b> device may malfunction or make noise in the following cases.</p>	<ul style="list-style-type: none"> <li>• When any part of your body contact the transceiver of the <b>Bluetooth</b> device or sound bar.</li> <li>• When there is an obstacle or wall or the device is installed in a secluded spot.</li> <li>• When there is a device(a wireless LAN, a medical equipment or a microwave) using same frequency, make the distance between the products as far away as possible each other.</li> <li>• When to connecting the device to the <b>Bluetooth</b> device, make the distance between the products as close as possible each other.</li> <li>• When the device gets too far from the <b>Bluetooth</b> device, the connection is disconnected and also malfunction may occur.</li> </ul>



---

## Trademarks and licenses

All other trademarks are trademarks of their respective owners.

---



Manufactured under license from Dolby Laboratories. Dolby, Dolby Audio, and the double-D symbol are trademarks of Dolby Laboratories.

---



The **Bluetooth®** word mark and logos are registered trademarks owned by the Bluetooth SIG, Inc. and any use of such marks by LG Electronics is under license. Other trademarks and trade names are those of their respective owners.

---

# Specifications

General	
Power requirements	Refer to the main label.
Power consumption	Refer to the main label.
	Networked standby : 0.5 W (If all network ports are activated.)
Dimensions (W x H x D)	Approx. 650.0 mm x 79.0 mm x 94.0 mm With foot
Operating temperature	5 °C to 35 °C
Operating humidity	5 % to 90 %
Available Digital Input Audio Sampling Frequency	32 kHz, 44.1 kHz, 48 kHz, 88.2 kHz, 96 kHz
Available Digital Input Audio format	Dolby Audio, PCM

Inputs	
OPT. IN (Digital audio in)	0 dBfs, Optical jack x 1
PORT. IN (Portable in)	0.4 Vrms (3.5 mm stereo jack) x 1

Amplifier (RMS Output power)	
Total	40 W RMS
Front	20 W RMS x 2 (4 $\Omega$ at 1 kHz, 10% THD)

- Designs and specifications are subject to change without prior notice.

# Maintenance

## Handling the unit

### When shipping the unit

Please save the original shipping carton and packing materials. If you need to ship the unit, for maximum protection, re-pack the unit as it was originally packed at the factory.

### Keeping the exterior surfaces clean

- Do not use volatile liquids such as insecticide spray near the unit.
- Wiping with strong pressure may damage the surface.
- Do not leave rubber or plastic products in contact with the unit for a long period of time.

### Cleaning the unit

To clean the player, use a soft, dry cloth. If the surfaces are extremely dirty, use a soft cloth lightly moistened with a mild detergent solution. Do not use strong solvents such as alcohol, benzene, or thinner, as these might damage the surface of the unit.

