

Product guide

Stand out with affordable business printing



HP Officejet Pro 6230 ePrinter



July 2014

Table of contents

- 3** Help your business grow
- 4** Product walk around
- 5** Product comparison
- 6** Top features at a glance
- 7** Professional colour for less than lasers¹
- 8** Print on your terms
- 9** Productivity features to keep business rolling
- 10** Save resources without sacrificing performance

Help your business grow

Impress customers and help your business grow with professional-quality colour documents and eye-catching marketing materials—for up to 50 percent lower cost per page than colour lasers.¹ Handle large printing jobs with the 225-sheet paper tray and automatic two-sided printing. Keep your business moving with easy mobile printing from work, home, or on the go.²

Who can benefit?

This ePrinter is ideal for cost-conscious business customers looking to boost productivity and print high-quality colour documents at a low cost. Designed for hassle-free use, this ePrinter offers easy mobile printing² to help keep your business moving. Plus, this ENERGY STAR[®] qualified compact, reliable printer uses up to 50 percent less energy than colour lasers,³ which can help reduce energy use and save money.



Product walk around

- 1 Simple and easy-to-use control panel
- 2 Integrated automatic two-sided printing
- 3 Output tray up to 60 sheets
- 4 Input tray up to 225 sheets
- 5 500 MHz processor, 128 MB RAM
- 6 Power connection
- 7 Integrated 802.11b/g/n wireless networking
- 8 Ethernet network port for easy sharing
- 9 Hi-Speed USB 2.0 printing port



Product comparison

The following table compares the new HP Officejet Pro 6230 ePrinter with the HP Officejet 6100 ePrinter.



HP Officejet Pro 6230 ePrinter



HP Officejet 6100 ePrinter

Benefits

Up to 18 pages per minute (ppm) black, up to 10 ppm colour print speed (A4) ⁴	Up to 16 ppm black, up to 9 ppm colour print speed (A4)	Faster black and colour print speeds help you get more done
Two-sided printing up to 8 images per minute (ipm) black, up to 5 ipm colour (A4) ⁴	Not available	Two-sided printing for more productivity
Up to 15,000 page monthly duty cycle ⁵	Up to 12,000 page monthly duty cycle	Improved reliability with up to 3,000 more pages
Internal power supply and integrated automatic two-sided printing	Not available	Smaller footprint saves space; reduce paper usage by up to half with automatic two-sided printing

Top features at a glance

Drive business success with professional colour for up to half the cost per page of lasers.¹ Easily print from all your devices—smartphones, tablets, Internet-connected notebooks, and PCs—across the office or on the go.² Save up to 50 percent on paper with automatic two-sided printing.



High-yield ink cartridges

Professional colour for less than lasers¹

- Look professional with every page, using Original HP pigment inks for vibrant, durable prints.⁶
- Count on a better value for frequent printing with optional Original HP high-yield individual ink cartridges.⁷
- Set the pace for success—with speeds up to 18 pages per minute (ppm) black and 10 ppm colour.⁴
- Save up to 50 percent on paper with automatic two-sided printing of documents and borderless colour brochures.



Automatic two-sided printing

Print on your terms

- Easily print documents, photos, and more, wherever business happens—in the office, home, or on the go—with HP Mobile Printing solutions.² Learn more at hp.com/go/mobileprinting.
- Enable wireless printing from mobile devices without the need for a router or a local network with HP wireless direct printing.⁸
- Connect this ePrinter to your local network and the Internet wirelessly,⁹ or with a wired connection using the 10/100 Ethernet port.
- Manage the ePrinter and scan on the go with the free HP All-in-One Printer Remote mobile app.¹⁰



15,000-page monthly duty cycle

Productivity features to keep business rolling

- Reload paper less often and handle large print jobs, using the 225-sheet paper tray.
- Depend on a printer with an up to 15,000-page monthly duty cycle.⁵
- Create high-impact materials that dry fast and resist fading for decades.⁶ HP recommends ColorLok[®] paper for best printing results.



HP Planet Partners

Save resources without sacrificing performance

- Save resources with this ENERGY STAR qualified ePrinter and use up to 50 percent less energy than colour lasers.³
- Conserve resources—use less supplies and packaging by weight compared with laser printers.¹¹
- Manage energy costs with HP Auto-Off Technology.¹²
- Count on easy cartridge recycling at no additional cost through HP Planet Partners.¹³

Professional colour for less than lasers

Make a professional impression with high-quality colour printing that can get your business noticed—for up to 50 percent less cost per page than lasers.¹ Original HP pigment inks produce vibrant documents that represent your business best.⁶ And with fast printing speeds, you can spend less time at your printer and more time focused on your work.

Professional colour for less than lasers

Make a lasting impression with professional-quality colour printing and keep your budget in check. This versatile ePrinter delivers vivid colour documents, brochures, flyers, and marketing materials for up to 50 percent lower cost per page than lasers.¹



4 individual inks

Quality results that last

This ePrinter uses four individual ink cartridges (black, cyan, magenta, and yellow), as well as specially designed print heads, so you replace only the ink cartridge that runs out. Original HP individual ink cartridges deliver consistent, high-quality, fast colour printing. Original HP pigment inks produce vibrant documents that show your business best and resist fading, water, and highlighter smears.⁶

Added value

Count on a better value for frequent printing with optional Original HP high-capacity individual ink cartridges. HP high-capacity individual ink cartridges allow you to produce up to twice as many pages as standard-capacity HP ink cartridges.⁷



Water-resistant prints

Speed through document tasks

The HP Officejet Pro 6230 ePrinter delivers black-and-white prints at speeds up to 18 ppm, A4 and colour prints up to 10 ppm, A4.⁴



Automatic two-sided printing

Easily print on both sides of a page

Help your business attract new customers and save up to 50 percent on paper with integrated automatic two-sided printing of documents and borderless colour marketing materials. Now it's easy to make your business look its best from the convenience of your office.

Print on your terms

Easily print from all your devices—smartphones, tablets, Internet-connected notebooks, and PCs—in the office or on the go.² Connect this ePrinter to your local network and the Internet wirelessly,⁹ or with a wired connection using the 10/100 Ethernet port. Print from any desk—it's that easy. Plus, manage this printer from your mobile device, using the free HP All-in-One Printer Remote mobile app.¹⁰



HP Mobile Printing



Wireless direct



HP ePrint



HP All-in-One Remote app

Simple mobile printing, wherever business happens

With HP Mobile Printing solutions, your ePrinter is equipped to easily print content from many of today's smartphones and tablets, whether you're at work, home, or on the go.² To learn more, visit: hp.com/go/mobileprinting.

- HP Slate and many Android OS 4.4 and later devices feature built-in printing via a pre-installed HP Print Service plugin—no software downloads are required.¹⁴ For devices without the pre-installed plugin, visit the Google Play store to download the HP Print Service plugin. If your Android device does not support OS 4.4, download the HP ePrint app from the Google Play store to enable easy mobile printing.¹⁵
- Print from your iPhone, iPad, and iPod touch using Apple AirPrint—no need to install anything.¹⁶
- Easily print from HP Windows® 8 notebooks, tablets, and PCs—no software downloads are required.¹⁷
- No access to a network? No problem. Print wirelessly from smartphones and tablets using HP wireless direct printing.⁸ Your ePrinter broadcasts its own Wi-Fi network for mobile devices to connect and send print jobs. This simple printing solution is great for office staff or visitors, when accessing a network is not possible.⁸
- Need to print while away from the office or on the go? Print documents, photos, and more using HP ePrint. Your ePrinter has a unique email address to send print jobs.¹⁸
- This ePrinter is also Google Cloud Print™ ready, with no need for print drivers or additional software.¹⁹ Simply register with your HP ePrint email address on Google's HP registration page: google.com/cloudprint/learn/setup-hp.html.

Wireless or Ethernet—you're covered⁹

This ePrinter is designed to be easy to set up and share with a small work team (up to five users). Integrated 802.11b/g/n networking and HP Auto Wireless Connect make it easy to connect the HP Officejet Pro to your wireless network automatically and print wirelessly right away.²⁰ Built-in Ethernet allows you to connect the device directly to a 10/100 Ethernet network. Either way, you'll enjoy effortless printing from any desk in the office.

Remote control for your printer

Manage this ePrinter and scan documents directly from your smartphone or tablet, using the free HP All-in-One Printer Remote mobile app.¹⁰ Check ink status, manage documents, and create high-quality documents with the camera-based intelligent mobile scanning feature.¹⁰

Productivity features to keep business rolling

Handle large print jobs without slowing down. Grow your business with an ePrinter you can count on to help you print what you need—at fast speeds—and move on to your next important project.



15,000-page monthly duty cycle



Fade-resistant prints

Increase productivity

- **Turn up the print volume.** Save trips to the supply closet. The 225-sheet paper tray easily handles large copy and print jobs so you can keep your business moving.
- **Performance you can count on.** Depend on a printer with an up to 15,000-page monthly duty cycle—the perfect fit for reliable colour printing.⁵
- **Lock in quality.** HP pigment inks create high-impact materials that dry fast and resist fading for decades.⁶ HP recommends ColorLok paper for best printing results.

Easy-to-use LED control panel

The HP Officejet Pro 6230 ePrinter offers users an easy-to-use LED control panel for quickly adjusting media sizes, assessing ink cartridge life, resuming or cancelling jobs, and accessing HP Mobile Printing and HP ePrint options.

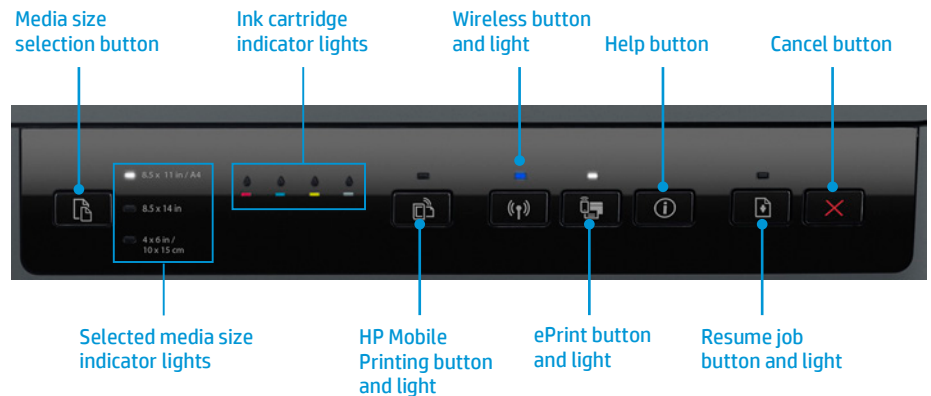

Save resources without sacrificing performance



Up to 50 percent less
energy use than laser³



HP Planet Partners

It has never been more important to save energy and resources, and HP technologies can help. HP's Design for the Environment initiative is driving improvements at every stage in the product lifecycle—helping reduce the amount of energy, paper, packaging, and materials used at HP and by our customers.

Conserve resources

With its intelligent design, this HP Officejet Pro ePrinter can help you meet your energy goals and reduce your environmental impact:

- **Reduce energy use.** Save resources with this ENERGY STAR qualified ePrinter and use up to 50 percent less energy than colour lasers.³
- **Less weight, less waste.** Use up to 80 percent less supplies and packaging by weight compared with colour lasers.¹¹
- **Save energy automatically.** Save energy by presetting your device to turn on when you need it and off when you don't.

Easy cartridge recycling

Reduce your impact on the environment. Easily recycle your Original HP ink cartridges for free through HP Planet Partners.¹³

Notes

¹ Cost-per-page (CPP) claim compares the majority of multi-pass colour laser printers <€200 EUR excluding VAT, as of February 2014, based on market share as reported by Q4 2013 IDC. CPP for laser supplies are based on published specifications of the manufacturers' highest-capacity cartridges. HP Officejet Pro CPP based on HP 934XL/935XL ink cartridges estimated street price, published yield and continuous printing. Actual prices may vary. Actual yields may vary based on images printed and other factors. For more information, see hp.com/go/learnaboutsupplies.

² Local printing requires mobile device and printer to be on the same wireless network or have a direct wireless connection. Wireless performance is dependent on physical environment and distance from access point. Wireless operations are compatible with 2.4 GHz operations only. Remote printing requires an Internet connection to an HP web-connected printer. App or software and HP ePrint account registration may also be required. Wireless broadband use requires separately purchased service contract for mobile devices. Check with service provider for coverage and availability in your area. See hp.com/go/mobileprinting for more details.

³ Majority of multi-pass colour laser printers <€200 EUR excluding VAT, as of February 2014, based on market share as reported by Q4 2013 IDC; ISO yield with highest-yield cartridges. Energy use is based on internal HP testing. Actual cost and energy usage may vary

⁴ After first set of ISO test pages. For more information, see hp.com/go/printerclaims.

⁵ Duty cycle is defined as the maximum number of pages per month of imaged output.

⁶ Fade resistance based on paper-industry predictions for acid-free papers and Original HP inks; colourant stability data at room temperature based on similar systems tested per ISO 11798 and ISO 18909. Water resistance based on HP internal testing, using paper with the ColorLok logo.

⁷ Based on HP 934XL High Yield Black Original Ink Cartridges and HP 935XL High Yield colour ink cartridges. High-yield ink cartridges not included; purchase separately. For more information, see hp.com/go/learnaboutsupplies. Value compared with estimated street price and average page yield of standard-yield HP 934/935 ink cartridges. Actual pricing may vary.

⁸ Mobile device must be connected directly to the Wi-Fi network of a wireless direct-capable printer prior to printing. Depending on mobile device, an app or driver may also be required. Wireless performance is dependent on physical environment and distance from the access point in the printer.

⁹ Wireless performance is dependent on physical environment and distance from access point. Wireless operations are compatible with 2.4 GHz routers only.

¹⁰ Mobile device requires wireless access point and an Internet connection. Compatible with iPhone 4 and later, iPad 4th generation, iPad mini, iPad Air and iPod 5G using iOS 7 or later, and mobile devices using Android 4.0.x or later. Features controlled may vary by mobile device operating system. Scan/copy control requires mobile device and printer be on the same wireless network or through wireless direct connection to printer. For mobile scanning, device camera requires 5 megapixels or greater with autofocus capability.

¹¹ Compared with the majority of multi-pass colour laser printers <€200 EUR excluding VAT, as of February 2014, based on market share as reported by Q4 2013 IDC. Calculation compares weight of supplies and cartridge packaging needed for the same amount of pages based on ISO yield and continuous printing.

¹² HP Auto-Off Technology capabilities subject to device and settings.

¹³ Program availability varies. Original HP cartridge return and recycling is currently available in more than 49 countries, territories, and regions in Asia, Europe, and North and South America through the HP Planet Partners program. For more information, visit hp.com/recycle.

¹⁴ Solution supported on all HP Slate Android devices, including HP Slate 7, HP Slate 7 HD, HP Slate 7 Extreme, HP Slate 8 Pro, HP Slate 10 HD, and HP Slate 21 AIO.

¹⁵ Supports Samsung devices powered by Android OS 4.1 Jelly Bean or newer, including Samsung Galaxy S4, and HP Slate 7. Requires the printer be connected to the same network as your compatible mobile device. Remote printing requires an Internet connection to an HP web-connected printer, HP ePrint app, and HP ePrint account registration. Wireless performance is dependent on physical environment and distance from the access point. Wireless operations are compatible with 2.4 GHz routers only. Wireless broadband use requires separately purchased service contract for mobile devices. Check with service provider for coverage and availability in your area. See hp.com/go/mobileprinting for more details.

¹⁶ Supports Apple OS X Lion, OS X Mountain Lion, and the following devices running iOS 4.2 or later: iPad (all models), iPhone (3GS or later), and iPod touch (3rd generation or later). Works with HP's AirPrint-enabled printers and requires the printer be connected to the same wireless network as your OS X or iOS device. Performance is dependent on physical environment and distance from the wireless access point. Wireless operations are compatible with 2.4 GHz routers only.

¹⁷ Select drivers on some OS versions may need to be activated before use.

¹⁸ Check your compatible device's official app store for HP ePrint app download availability. Requires an Internet connection to an HP ePrint-enabled printer. Printer requires ePrint account registration. App or software may be required. Wireless operations are compatible with 2.4 GHz operations only. Print times and connection speeds may vary. Wireless broadband use requires separately purchased service contract for mobile devices. Check with service provider for coverage and availability in your area. Learn more at hp.com/go/mobileprinting.

¹⁹ Google™ and Gmail are trademarks of Google Inc. Feature requires Google Cloud Print Ready printer or existing printer connected to a PC with Internet access. Print times may vary. Currently only Google apps are supported.

²⁰ HP Auto Wireless Connect may not be available for all system configurations. Wireless performance is dependent on physical environment and distance from access point. Wireless operations are compatible with 2.4 GHz routers only. For information on compatibility, visit hp.com/go/wirelessprinting.

Sign up for updates

hp.com/go/getupdated



Share with colleagues



Rate this document

© Copyright 2014 Hewlett-Packard Development Company, L.P. The information contained herein is subject to change without notice. The only warranties for HP products and services are set forth in the express warranty statements accompanying such products and services. Nothing herein should be construed as constituting an additional warranty. HP shall not be liable for technical or editorial errors or omissions contained herein.

AirPrint and the AirPrint Logo are trademarks of Apple Inc. iPad, iPhone, and iPod touch are trademarks of Apple Inc., registered in the U.S. and other countries. ENERGY STAR and the ENERGY STAR mark are registered U.S. marks. Android, Google, Google Play and Gmail are trademarks of Google, Inc. Windows is a U.S. registered trademark of Microsoft Corporation.

4AA5-3452EEW, July 2014

