

# Screen Assembly Instructions

- 1: Unroll the fabric from the top bar.

2: Insert the corner brackets into each end of the top bar.
- 3: Slide the side channels onto the zip on each side of the fabric and onto the corner bracket

4: Lower the assembled screen onto the feet

Your screen is now ready for use!

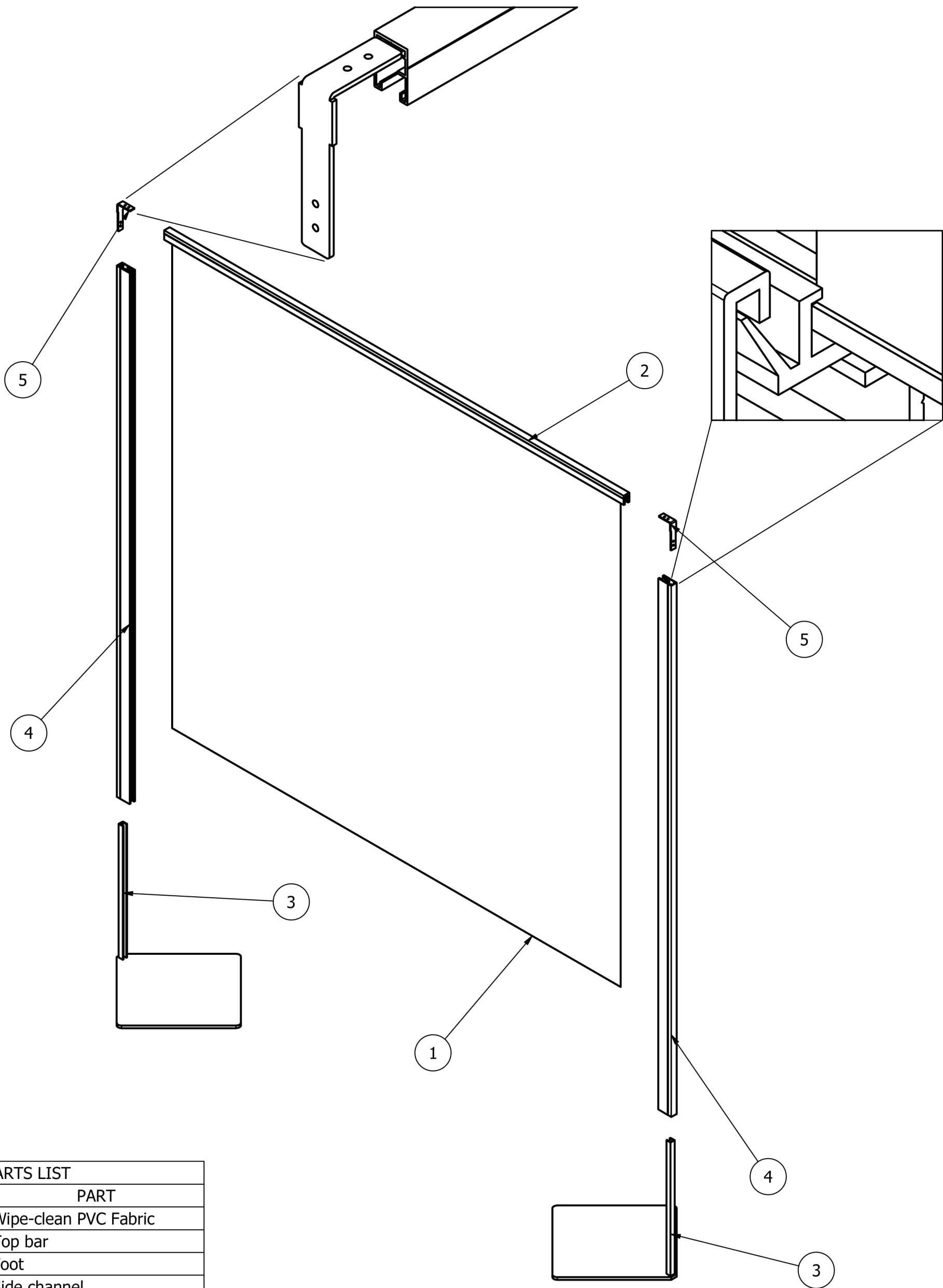

PARTS LIST	
ITEM	PART
1	Wipe-clean PVC Fabric
2	Top bar
3	Foot
4	Side channel
5	Corner bracket